

HORIZON

FOR THE YACHT OWNER WHO DEFINES DREAMS

A three-time Horizon owner creates the largest, most extravagant Horizon yacht to grace the Australian coastline.

FD SERIES OWNERS TEST THE
HIGH PERFORMANCE PIERCING BOW

+ *Destination Spotlight: Hamilton Island*



A DESTINATION UNLIKE ANY OTHER...
...AN EVENT TO BE REMEMBERED

^{2ND}—GLOBAL
HORIZON
YACHTS
OWNER RENDEZVOUS —



SEPTEMBER 19TH TO 22ND, 2019
HAMILTON ISLAND, AUSTRALIA

Mark your calendars and prepare to make memories of a lifetime with fellow Horizon owners in one of the world's most spectacular destinations. The gateway to the Great Barrier Reef and Australia's Whitsunday Islands, Hamilton Island offers an exclusive tropical paradise with luxury amenities surrounded by the most breathtaking cruising grounds. Itinerary includes excursions, activities and adventures to maximize the enjoyment of this beautiful destination.

For more information, please contact Horizon Yacht USA
Danett Utecht +1 561-721-4850 danett@horizonyachtusa.com

CEO MESSAGE

RESOLVING THE DESIGN CONFLICT

For more than 30 years, the

Horizon Group has continuously developed new products, creating an average of one new model

per year for our diverse range of yacht series. Each new product concept is met with intense scrutiny during the design phase – a challenging process that calls for precision, accuracy and solutions to the ever-present “design conflict.”

This “design conflict” exists at the epicenter of every yacht’s conceptualization, design and build, and balance is the key to success. Comfortable living space must be accompanied by an increase in boat weight; but the weight must not compromise the cruising speed. The exterior profile must be streamlined and attractive, while not impeding on interior space. Market lifestyle preferences and country regulations add further factors for consideration. Each of these design conflicts must be resolved to ensure that the new product is competitive – and unique.

Marked by a bold design that immediately distinguishes its yachts from other yacht designs, the Fast Displacement (FD) Series is a recent addition to the Horizon fleet. Born out of a design formula resulting from the integration of various market demands, customer feedback and abundant experience in yacht



building, the FD Series boasts true global appeal, attracting clients from the U.S., Europe and Australia. With the build and sale of a record 22 FD Series yachts in less than three years, the FD Series is a remarkable achievement in resolving the “design conflict.”

People always remember the pioneers: the first person to walk on the moon, or the first person to discover the New World. The development of the FD Series has been like being that first explorer who dares to attempt what others have not achieved, knowing that each attempt will be accompanied by unforeseen challenges and risks. The global success of the FD Series is a testament to the great accomplishments that can be achieved when there is a willingness to embrace the passion and courage for exploration. This is the spirit of Horizon – the spirit to pioneer, to resolve the design conflict, to always strive to surpass the goal!



John Lu
CEO of Horizon Group

HORIZON

Founded in 1987, Horizon Yachts has celebrated 30 years as one of the largest luxury yacht builders in the world as well as the number one builder in the Asia Pacific region. Over the past three decades, Horizon has delivered over 820 luxury yachts, with more than 205 of these over 80 feet in length. Popular models ranging from 52 to 150 feet include motor yachts, superyachts, power catamarans, expedition yachts, and fast displacement motor yachts.

PUBLISHER
John Lu

MARKETING DIRECTOR, HQ
Joey Lu

MARKETING DIRECTOR, U.S.
Elise Moffitt

EDITORIAL COORDINATORS
Michelle Huang, Lily Li, Celeste Chang, Vincee Wu, Lisa Yang

SUPERYACHT CREATIVE

EDITORIAL DIRECTOR
Rebecca Cahilly-Taranto

CREATIVE DIRECTOR
Richard Taranto

All particulars in this magazine are believed to be correct but cannot be guaranteed. No part of this publication may be reproduced or duplicated without written permission from Horizon Yachts.
©Horizon Yachts 2019. Advertising opportunities: marketingcenter@horizonyacht.com. Letters to the editor: marketingcenter@horizonyacht.com

You've Always Had to Compromise...
Until Now



THE BRAND **NEW** FD77

OWNERSHIP WITHOUT COMPROMISE.

We believe yacht ownership should have as few compromises as possible. Specified to accommodate owner operation, the new FD77 is packed with ingenious amenities within an innovative hull designed for comfort and performance. With high-end systems, multiple layout configurations, and our encouragement for owner customization, you can finally have it all.

DEFINE YOUR HORIZON

FD SERIES: FD70 // **FD77** // FD85 // FD87 // FD102 // FD125

USA

+1 561 721 4850
horizonyachtusa.com

EUROPE

+34 971 673 508
horizonyachteurope.com

AUSTRALIA

+61 7 5577 9009
horizonyachtaus.com



HORIZON
WORLD CLASS YACHTS

// CONTENTS

2 CEO Message

NEW WAVE

8 New Concept: Unveiling the new FD125 concept

10 Sales: FD Series Order Book update

12 New Launches: Twin RP110 launches

14 New Launches: The FD77 Skyline

Step aboard the brand new FD77 Skyline, which debuted at the Sanctuary

Cove International Boat Show in May.

20 Technology: High Performance Piercing Bow

For the revolutionary FD Series, it's what's beneath the waterline that sets this voluminous series apart from the competition.

DESTINATION:

Hamilton Island

The gateway to the Great Barrier Reef and Australia's Whitsundays, Hamilton Island offers some of the world's most spectacular cruising grounds. It's also the site of the Horizon Global Owner's Rendezvous in September.



54

HORIZON LIFE

38 On Location: Horizon FD87 Skyline owners enjoy the Bahamas

40 Happy Hour: Onboard with FD85 owner Jim Loomis

Serial boat owner Jim Loomis shares with us his love of yachting and the events that led him to join the Horizon family.

44 Boat Show Recap: Palm Beach International Boat Show

48 Boat Show Recap: Sanctuary Cove International Boat Show

50 Asia Boating Awards

51 Calendar of Horizon Global Events

52 Upcoming Events: Sydney, Cannes and Monaco Yacht Shows



ON THE COVER

The new RP110 *The Legion* captured on sea trials in Taiwan.

FEATURE YACHT:

Horizon RP110 The Legion

When this experienced owner teamed up with Cor Rover and Horizon to collaborate on his next yacht, the result was nothing short of amazing.



PAID ADVERTISEMENT



ABT·TRAC
STABILIZERS · THRUSTERS · HYDRAULICS
WWW.ABTTRAC.COM



HEADHUNTER 

NEW WAVE

— ALL OF THE LATEST NEWS FROM THE YARDS —



NEW LAUNCHES // TECHNOLOGY AND INNOVATION // FUTURE DESIGN CONCEPTS →

DEFINE YOUR HORIZON

FIRST LOOK

FD125

Expansive windows and a beach house feel define the interior of the FD125 design concept, which incorporates double salons, a spacious galley, five staterooms including an on-deck deluxe master, and accommodations for eight crew. The FD125 pairs performance with superyacht luxury. ➔



MASTER BATH





Specifications

LOA

38m (125')

Design

Cor D. Rover/Horizon

Guest Accommodations

10 in 5 staterooms

Crew

8

Series

Fast Displacement (FD)



FD Series 2019 Order Book

available in print or online at
www.horizonyacht.com



Horizon's Fast Displacement Series has seen record sales in the last 3 years, with fifteen FD Series yachts sold and delivered to clients hailing from the U.S., Australia, Europe, and Asia.



FD102

What makes a successful yacht model? It's the question that most production and custom yacht manufacturers build their brands upon. The experts say that success requires a combination of performance, style, and amenities backed by a strong brand, sound design and quality construction. These points may

sound easy enough to achieve, but when competing in the mid-range arena (between 60 and 140 feet in length), the competition is fierce and savvy buyers turn to yachts that require fewer compromises.

When Horizon Yachts partnered with designer Cor D. Rover to collaborate on an 85ft fast

THESE PAGES

The head-turning styling of the FD Series is complemented by bright and voluminous interiors as well as stability and performance.



displacement motor yacht, the exterior styling alone – with its expansive sections of glass and geometric references in the superstructure – would have been enough to capture the fashion forward among yacht buyers. But when this styling was accompanied by an interior volume that is unrivalled in its size range and positioned atop an innovative High Performance Piercing Bow and hull design, the competition thinned out. As the Fast Displacement Series evolved and owners and the yard’s naval architecture teams joined Cor at the drawing boards to incorporate new features and ingenious amenities, word spread about the exciting new FD Series, and those in the know agreed that the Horizon FD would be a yacht to watch.

Since the first FD Series yacht, an FD85, was unveiled at the Taiwan International Boat Show in 2016 and subsequently sold to a Japanese client, the series has grown to include the FD87, FD77, FD102

and the upcoming FD70, all offered in multiple layout configurations with endless options for customization. A series with global appeal, FD yachts are equally sought after by American, European, Asian, and Australian owners.

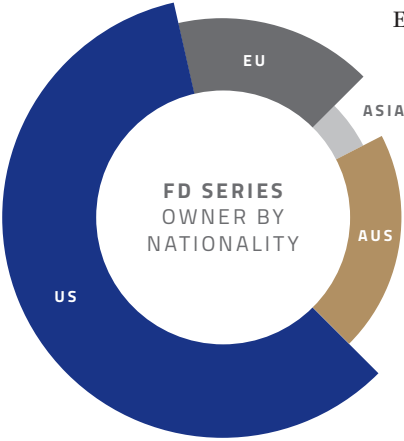

From beach clubs to helipads, innovative fore-deck entertainment areas, and walkaround side decks, the FD Series yachts have incorporated exceptional owner-specified features that have served to set this series apart in the mid-range yacht arena. The success continues throughout the range, with the recent sales of two FD102s, two FD87s, and an FD77. Production at the yard continues at full pace, with another FD87 and the FD77 Hulls 3 and 4 slated for the American and Australian markets. Track the progress of the FD Series and the variety of custom options incorporated into each build with the new FD Series Order Book, available by contacting us at www.horizonyacht.com. ➡

FD SERIES ORDERS BY MODEL



FD70 // 2019 – PRESENT



FD77 // 2018 – PRESENT



FD85 // 2016 – PRESENT



FD87 // 2016 – PRESENT



FD102 // 2017 – PRESENT

Horizon Yachts Celebrates the Launch of Twin RP110 Superyachts

Built for two clients who share a unique Horizon yacht ownership story, two RP110 Superyachts join their new owners on opposite continents.

RP110 HULL 7
Owner Nationality: Australian
Previous Yachts: Horizon E78, E88



It's a story of being separated at "berth" for twin RP110 Superyachts, which recently launched and delivered to their respective owners in the U.S. and Australia. Despite hailing from different continents, these owners shared a unique yacht ownership path, which began in 2012 when they each purchased a Horizon E78. From there both moved into Horizon E88 yachts before commissioning their own RP110 Superyachts which, coincidentally, were tank tested together prior to being delivered in the same month.

The RP110 Hull 5 has been built for a third-time Horizon owner from the U.S. Featuring a double chine hull designed by Donald Blount, this RP110 is a true superyacht throughout, from style and amenities to performance.

Both owners each moved from an E78 to an E88 before commissioning a new RP110.



Within her 25' beam, the owner commissioned Italian designer Luca Dini to incorporate a casually elegant décor that pervades the spacious and flexible four-stateroom layout. Owing to Horizon's willingness to customize to owner specification, the salon of this RP110 has been fitted with an exquisite 150-bottle wine storage unit, which was customized to satisfy the oenophile owner's wine collection hobby.

Featuring exterior styling from J.C. Espinosa and an interior designed by Cor D. Rover, the second Horizon RP110, Hull 7, (featured on page 24) has been tailored to her Australian owners' preferences. Distinguished by an exterior profile that features floor-to-ceiling windows on the deckhouse and a dramatic dark blue hull, this yacht has been designed with a combined skylounge/open bridge configuration that offers an enclosed, climate-controlled skylounge for family gatherings as well as open visibility from the bridge. Measuring 10' 10", the swim platform is large enough to facilitate sunning and water sports and can easily launch a three-ton tender.

"The coincidences surrounding these two RP110s are most unusual," says Horizon Group CEO John Lu, "and we wish each owner many wonderful experiences aboard these two beautiful, high-performance superyachts." ➔



WORLD DEBUT

FD77 Skyline



The FD77 Hull Two is not only the first Skyline

version of the model, it is also the first FD77 to be delivered to Australia. Incorporating the same exciting features that characterize the FD Series, such as large windows, an expansive 22'8" beam, and a striking exterior profile that presides atop Horizon's High Performance Piercing Bow hull design, the compact FD77 has been purposely designed for owner operation.

Fitted with numerous owner-inspired amenities, the FD77 Skyline offers four staterooms, including an on-deck master suite. The spacious master features large windows that bring copious natural light into the interior, a large en suite, and →



THESE PAGES

The enclosed bridge/Skyline design protects the wheelhouse and lounging area aft from the elements.





a seating area with a sofa and built-in vanity with drawers. Three additional guest staterooms are found below deck – one VIP cabin at the bow, one large guest cabin amidships, and a twin cabin. The extended main salon features a bright and contemporary décor with functional amenities,



such as the innovative convertible dining table that can easily fold up into a breakfast bar. The galley can be separated from the salon via privacy doors and a Hi/Lo island partition.

On the upper deck, the enclosed skylounge features a dayhead and a relaxed dinette area with low coffee tables. Doors to port and starboard provide access to the walkaround side decks.

OPPOSITE PAGE

Twin MAN V8 1200hp diesel engines power the FD77 to a maximum speed of 18 knots at half load.



An inviting Jacuzzi graces the deck space aft of the enclosed skylounge. Here, guests can enjoy panoramic views from the spa pool or at the attached bar.

THESE PAGES
Bathed in natural light,
the interior spaces
feature innovative
amenities, such as
a convertible dining
table/breakfast bar.



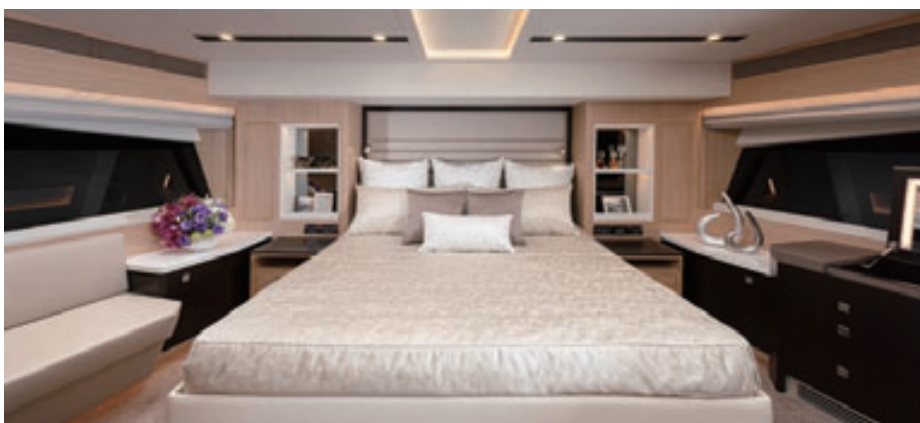

Specifications

LOA

80' 7" (24.56m)

Beam

22' 8" (6.91m)

Guest Accommodations

8 in 4 staterooms

Crew

2 in 1 cabin

Engines

2 x MAN V8 1182hp

The incorporation of a walkaround design on the bridge deck allows guests to transition between the enclosed skylounge, aft boat deck, and forward entertaining area with ease. Aft, the boat deck is designed for entertainment and offers a bar alongside the inviting Jacuzzi and grill area just beyond the skylounge.

Another impressive feature for a 77ft yacht, the FD77 Skyline showcases an innovative beach club, which accesses the Hi/Lo swim platform. This functional area is an inviting space for enjoying cocktail hour or simply relaxing on the water. ➡

Beneath the Waterline

Horizon's Fast Displacement Series may be most recognizable for its exterior styling, but it is what lies beneath the waterline that sets this series apart.

Designed in collaboration with Cor D. Rover,

Horizon's Fast Displacement (FD) Series of motor-yachts and superyachts is nothing short of head-turning, thanks in part to the oversized windows, voluminous interior, and well-planned entertaining spaces wrapped in a stylish package. While the exterior styling of this pioneering series—first introduced at the 2016 Taiwan International Boat Show—attracts attention, it is the hull platform and proprietary bow design that sets the series apart from similarly-styled yachts.

ANATOMY OF OUR HULL DESIGN

Tunnel

A properly designed tunnel will reduce resistance and decrease draft.

Hard chine

A hard chine at the bow ensures a dry ride and increases the lift force.

Soft chine

A soft chine mid-ship & aft in the hull generates smaller waves and reduces the resistance hump at hull speed. This hull design delivers lower resistance and a smooth transition in all speed ranges for more efficient cruising.

High Performance Piercing Bow (HPPB):

The High Performance Piercing Bow is not only designed for high efficiency but also for a greater hull speed. The submerged sharp bow underwater makes it easier to cut through underwater currents, so the HPPB increases the length of the waterline and reduces the entrance angle of the bow wave. This also enhances ride comfort in head seas by damping the motion while benefitting the hydrodynamic performance across the board.

Long skeg

The long skeg offers larger lateral underwater surface area and excellent directional stability. These two features offer good maneuverability and increase comfort for onboard guests.

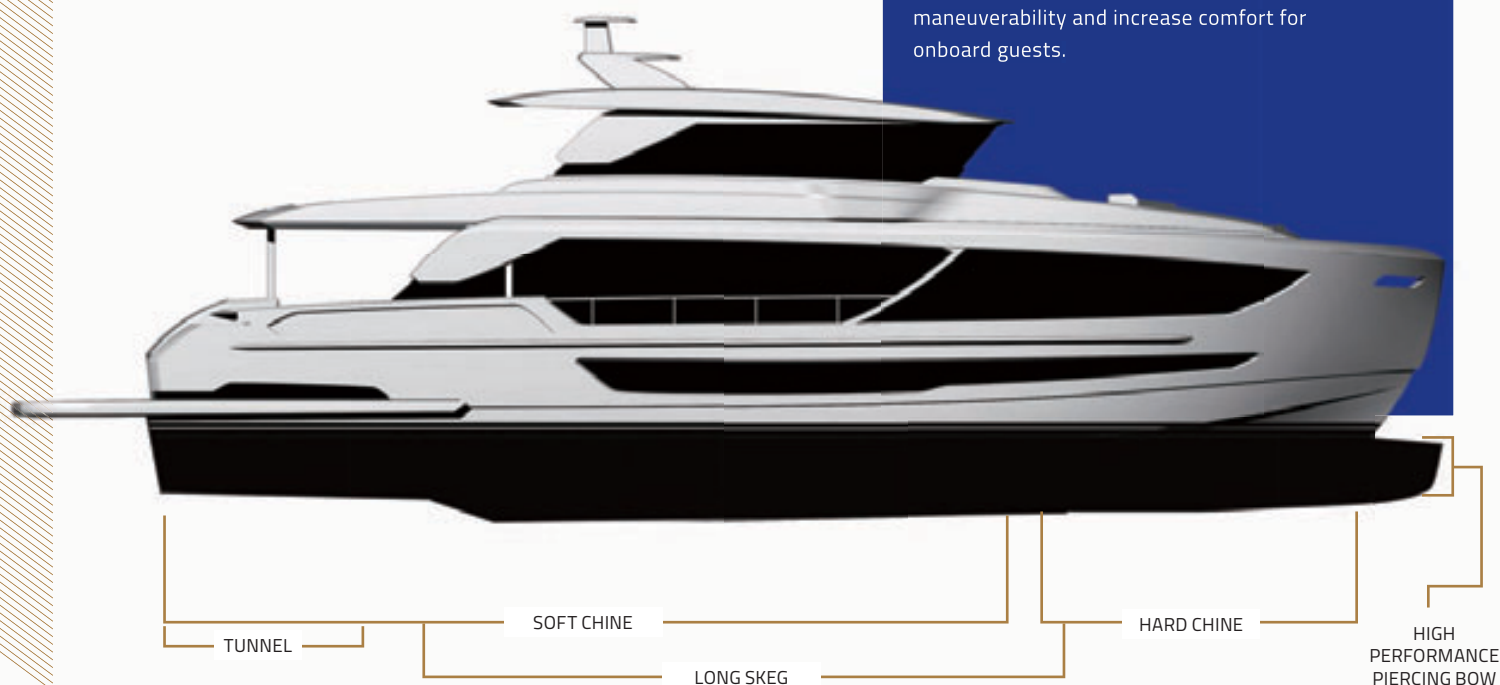

FD85 Performance Figures

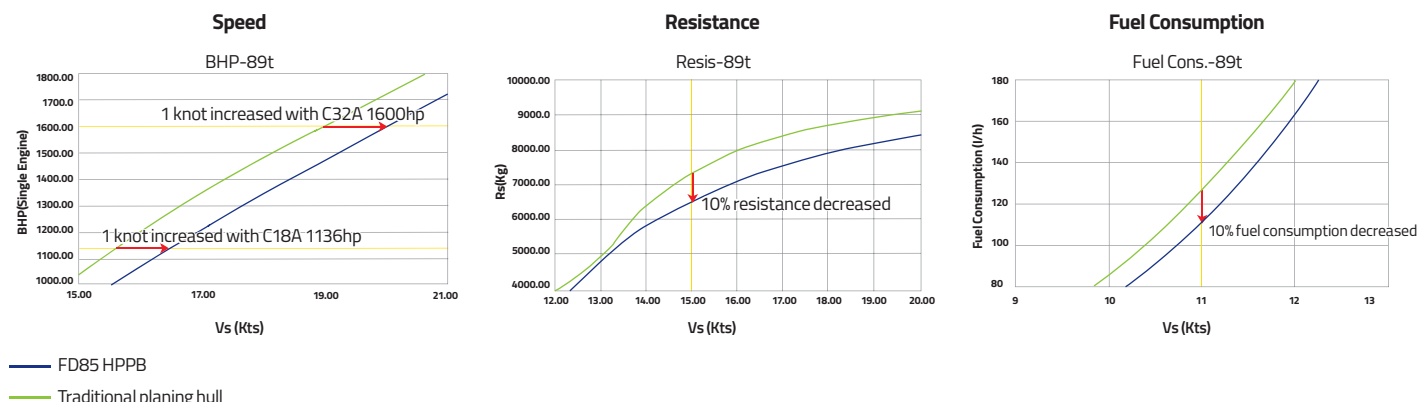

Efficiency and performance must accompany style in yacht design, and such aspects formed the basis of the design conversation as the Fast Displacement series evolved to include new models. Comprised of a hybrid hull shape and tunnel design, Horizon's High Performance Piercing Bow (HPPB) delivers a shallow draft, more comfortable ride, lower resistance and excellent stability in comparison to a traditional fast displacement, hard-chine hull design.

The FD Series' hull features both hard and soft chines—a hard chine at the bow to increase lift force and a soft chine midship and aft to reduce resistance. A well-designed tunnel aft further reduces resistance and decreases draft. The sharp underwater bow protrusion cuts through currents with ease and reduces the entrance angle of the bow wave while increasing waterline length. This enhances ride comfort in head seas by damping the motion and improving hydrodynamic performance across the board. The HPPB design also features a long skeg that offers a longer lateral underwater surface area and yields excellent directional stability.

CFD and tank testing of the HPPB design resulted in across-the-board hydrodynamic improvements in comparison to a traditional design. While alternative bow designs that feature protrusions work efficiently at either high or slower speeds, the HPPB delivers lower resistance and a smooth transition in all speed ranges, bringing both efficiency at slower speeds and performance at higher speeds.

Returning from a 5242nm journey from Taiwan to Australia aboard his brand new yacht, the owner of the FD85 Julind said, "Although we encountered some reasonably rough seas upwards of 5 meters, the FD85 is an unbelievable sea vessel. She came into her own and performed flawlessly. The combination the FD hull along with the lighter superstructure and the stabilizer is a fantastic outcome."

The success of the HPPB is a milestone for Horizon's highly trained and experienced research team as they continue their efforts to innovate. First implemented on the FD85 and FD87 Skyline models, the HPPB design is now standard for the FD Series – further proving these luxury yachts as truly revolutionary. ➡

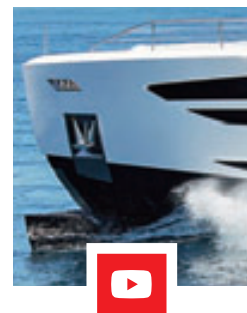

VIEW MORE ON YOUTUBE
Subscribe to the Horizon Yacht USA YouTube channel for great video content, including the HPPB in action.

"Although we encountered some rough seas upwards of 5 meters, the FD85 is an unbelievable sea vessel. She came into her own and performed flawlessly. The hull and stabilizer combination with a light superstructure is fantastic."



+1 604.272.1305



+1 360.398.8228



+886 7.355.9311



+1 888.828.5765



www.vertex-marine.com



+886 7.355.9918



Vertex
MARINE

SUPERIOR
MARINE
CABLE
SOLUTIONS



FLEXIBLE FINE STRANDED

THE

A three-time Horizon owner creates the largest, most extravagant Horizon yacht to grace the Australian coastline.

LEGION

FEATURE YACHT

The third time is the charm for the owner of the brand new Horizon RP110, *The Legion*, who previously owned two smaller Horizons before building this custom yacht. This is also a significant build for Horizon, as it represents the largest, most luxurious Horizon yacht to ever be delivered to the Southern Hemisphere and takes the position as a flagship vessel for The Horizon Group worldwide.

Having built 780 of custom yachts over the last three decades, Horizon has gained a reputation for flexibility in design and construction. This willingness to collaborate with its owners is one of the many distinguishing features that set Horizon apart as a yacht builder. Because clients are able to build a vessel that truly suits their boating lifestyle, Horizon enjoys a high number of repeat clients, who appreciate the collaborative design and build process and effortless customization that Horizon provides.







The Legion began at the drawing board with a review of the established RP110 platform, designed by J.C. Espinosa.

throughout. The luxurious décor features high-gloss ebony timber, bronze and black accents, marble flooring and counter tops, and designer fixtures such as the door handles, mirror frames, and light fixtures of Swarovski crystal. In the



TOP PHOTO

The custom built carbon fiber swim platform from Artifex enables an expansive beach club entertaining area.

For this experienced Australian owner, the design of *The Legion* began at the drawing board with a review of the established Horizon RP110 platform, designed by J.C. Espinosa, to which the owner requested a hull extension of five feet as well as the addition of a ten-foot, ten-inch swim platform – customizations that resulted in a total LOA of 121' 10" and allowed for an enlarged aft deck entertaining area and a custom beach club equipped with a sauna.

To execute his innovative spatial concepts and lifestyle requirements for the yacht's interior, the owner turned to renowned designer Cor D. Rover, the creative mind behind the acclaimed Fast Displacement Series. Maximizing the additional space afforded by the hull extension, Rover and the Horizon design team incorporated a spacious interior layout within the 25' beam, with floating floors for sound attenuation and high-end detailing





LEFT
The swim platform extension resulted in an overall length of 121' 10" without compromising the yacht's sleek exterior profile.



RIGHT AND BELOW
Luxurious and inviting, the main deck aft's semi-circular settee mimics the shape of the crystal chandelier, also echoed by the curved stairway to the bridge deck and enclosed skylounge.







THESE PAGES
Within the truly stunning interior, designer Cor D. Rover incorporated intimate, homey spaces. Extraordinary bronze and velvet details accentuate the effortless mix of new materials and traditional craftsmanship.



Designed to provide the ultimate indoor/outdoor experience, the spacious flybridge features a custom designed octagonal Jacuzzi for ten, indoor bar, and entertainment area.



THIS PHOTO
The Scout 255LXF tender is easily accommodated by the swim platform.



spacious yet homey main salon, a 10ft hand-cut crystal chandelier serves as the centerpiece.

To accommodate her ten guests, *The Legion* offers a large main-deck master suite and four staterooms forward on the lower deck. Quarters for four crew are situated aft. The master is exceptionally well laid out with a king-sized bed, a shower steam room, fiber optic star overhead lighting feature, full-height walk-in wardrobe, and natural stone surfaces.

The spacious lower deck staterooms continue the Art Deco theme of the salon, with hi-gloss ebony timber and black and gold accents. Guest areas are decorated with high-end designer furniture from Bvlgari, Gucci, Fendi, and Versace, echoing the tone of luxury that defines the vessel.

Deck areas are maximized aboard *The Legion*, which features a walkaround design on the main deck that links the spacious forward bow seating area for ten guests to the expansive aft dining and

Inspired Features

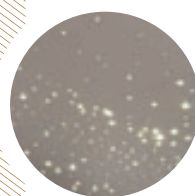

star ceiling
in on-deck
master



custom 10-foot-
wide Swarovski
crystal chandelier



custom built
carbon fiber
swim platform

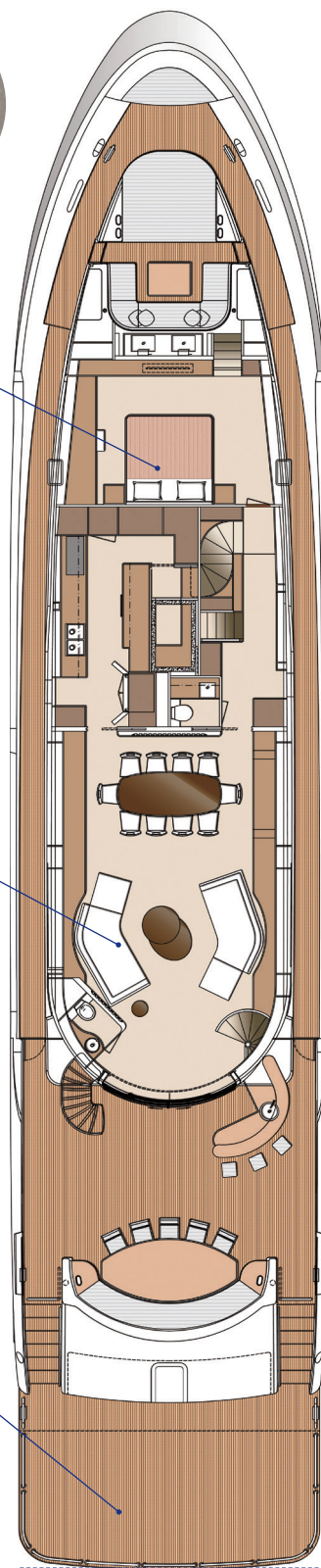

10' 10"

MAIN DECK

Measurements for visual representations only

THIS PHOTO

Designed to enable a range of 1800nm at 10 knots, *The Legion* tops out at 19 knots.



bar area. Two day heads have also been specified for this deck, the second situated aft to accommodate guests from the swim platform and exterior areas.

Designed to provide the ultimate indoor/outdoor experience, the spacious flybridge features a custom designed octagonal Jacuzzi for ten, a bar, and entertainment area. Two Sea-Doo Jetskis and a Steelhead 2500 hydraulic davit are also stored furthest aft on this deck.

The owner's most noteworthy implementation was the custom built carbon fiber swim platform from Artifex that easily accommodates the Scout 255 LXF tender. Fitted to this superyacht is an impressive customized Besenzone stainless steel

Specifications

LOA

121' 10" (37.13m)

Beam

25' (7.62m)

Draft

6' 9" (2.07m)

Max Speed

19 knots

Interior Design

Cor D. Rover

Exterior Styling

J.C. Espinosa

Main Engines

2 x MTU 16V 2600hp

passerelle; the largest ever installed by Horizon.

The Legion is fitted with twin MTU V16 2600hp engines, the latest state-of-the-art Furuno Black Box navigation package, OctoPlex system, upgraded 440/20X ABT-Trac stabilizers, Yacht Controller, and an electric sunroof. The eye-catching profile is further enhanced by a deep navy blue hull which is dramatically set off at night by 28 blue underwater lights fitted around the hull.

Making her Australian debut at the Sanctuary Cove International Boat Show in May, *The Legion* is another benchmark of innovation for Horizon. She is now cruising with her owners and will call the beautiful Whitsunday Islands her home port. ➞

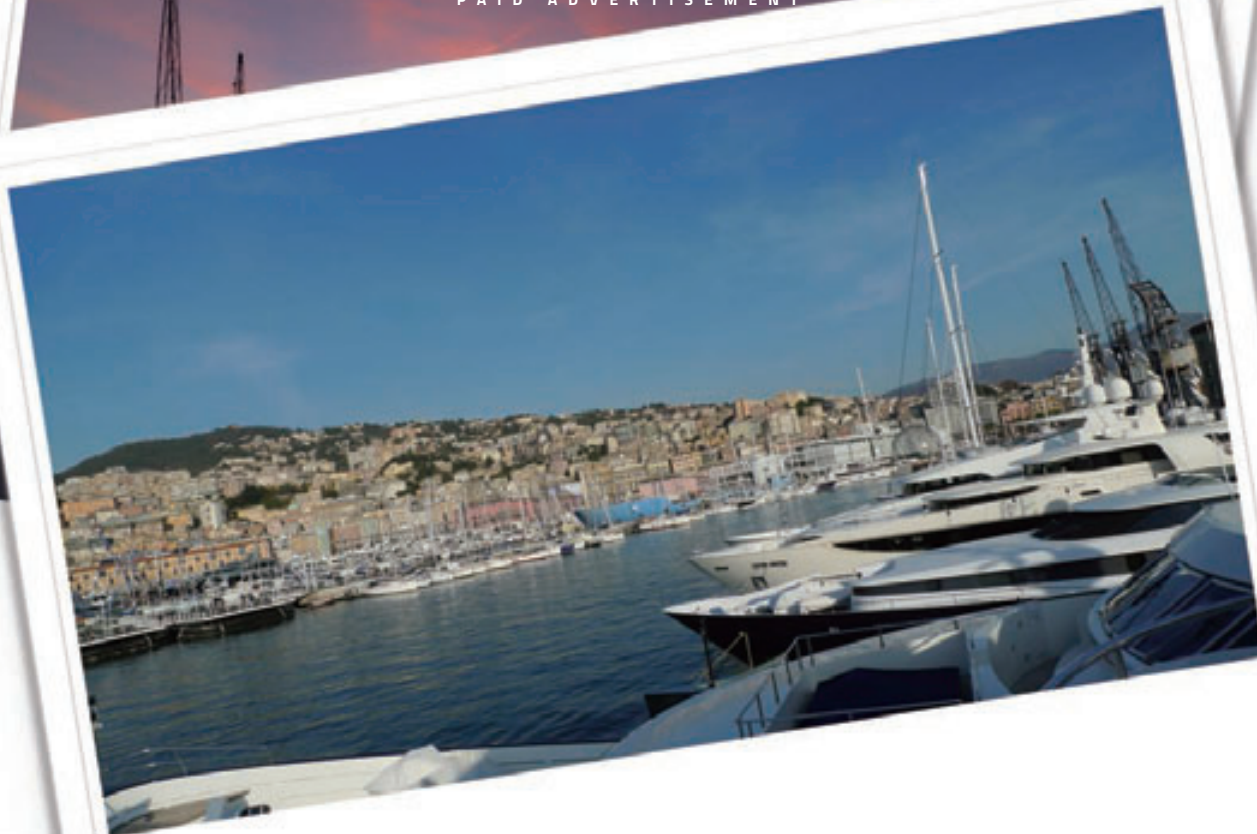

photography by Akito Tseng/ Project Manager of ARITEX

A person may play a variety of role. Mostly, I'm a hardware expert with knowledge and professional skill. But today, I'm a lucky photographer who could see such a beautiful scenery in the end of our service work. Despite this, nothing beats the sense of accomplishment of getting the job done.

Worked on Elizabeth II
at marina Porto Antico, Genova, Italy

WE SERVE YOU THE BEST

ARITEX

FEATURED INVENTORY VESSEL



RP SERIES: RP97 // **RP110** // RP120

HORIZON RP110

MULTI-FUNCTIONAL EXTERIOR AREAS AND SUPERYACHT SPACE

This spectacular RP110 can be viewed in Mallorca. For an appointment or more information, please contact Tom Boogaard at sales@horizonyachteurope.com



Horizon Yacht EUROPE
+34 971 673 508
horizonyachteurope.com

DEFINE YOUR HORIZON

The World is Vast
Venture Farther



THE BRAND **NEW** V68

EFFICIENT. VERSATILE. WITH A BEACH CLUB TO BOOT.

Conceived as a "mini superyacht", the V68 is equipped from stem to stern with every amenity desired aboard a long-range yacht. A wide beam, vertical bow and efficient hull design lend performance and stability to this exquisite Jonathan Quinn Barnett-designed motor yacht.

DEFINE YOUR HORIZON
V SERIES: **V68** // V72 // V80

USA
+1 561 721 4850
horizonyachtusa.com

EUROPE
+34 971 673 508
horizonyachteurope.com

AUSTRALIA
+61 7 5577 9009
horizonyachtaus.com

HORIZON
WORLD CLASS YACHTS

HORIZON LIFE

— DREAMS DEFINED. LIFE ON THE WATER. —



DESTINATIONS // HORIZON OWNERS // EVENTS // TOYS & EQUIPMENT →

DEFINE YOUR HORIZON

OWNER PERSPECTIVE

FD87 Skyline Compass Cay

YACHT NAME: Skyline
MODEL: FD87
OWNERS: American

The owners of the first FD87 Skyline, aptly named Skyline, have been enjoying every moment onboard their yacht since taking delivery in March of 2018. They regularly share stories and photos of their latest adventures throughout Florida and The Bahamas, including this shot captured recently in the tranquil waters of Compass Cay, Bahamas. ➞







Happy Hour with
JIM LOOMIS

*For Jim Loomis, the owner of the **Horizon FD85 Christine**, the ocean is always calling.
He recently sold his E88 and now has his eyes set on a new FD87.*

THESE PAGES

Mr. Loomis grew up boating on the Chesapeake Bay with his father and now shares this experience with his children and grandchildren.



WHEN IT COMES TO BOATS, JIM LOOMIS IS AS PASSIONATE AS IT GETS. THE PROUD OWNER OF THE FD85 *CHRISTINE*, MR. LOOMIS SPOKE WITH OUR EDITORS JUST AFTER FINISHING A CALL WITH THE REPRESENTATIVES AT HORIZON YACHT USA ABOUT A BRAND NEW FD87 SKYLINE.

***Q: Let's talk
about your
boating history***

"My father and I started boating on the Chesapeake Bay and the North East River when I was about eight or nine years old," Jim recalls. "My first boat was a rowboat; the second was a plywood boat with an Evinrude engine." By the time he was 15, Jim was enjoying the wind in his hair aboard a 16ft Crestliner he had fitted with a racing engine. "After that we just continued to leap forward in boats," he says. "When I was in my 20s I started fishing and my father – who is now over 100 years old – and I built a sportfish together at Jersey Yachts. Then I started on my own."

The yachts Jim has owned over the years reads like a who's who of production builders, his first being a 74ft Hatteras, followed by a couple of Lazzaras and a Cheoy Lee 103. "I've owned quite a few boats," he says. "I had a Lazzara and saw a Horizon E88 at a boat show, so I bought the E88 and traded the Lazzara. A year later, I'm at the Fort Lauderdale International Boat Show and I see this brand new FD85." The stars aligned and Jim was able to trade his E88 to another set of Horizon owners and take delivery of his new FD85.

Q: Tell us about Christine

All of Jim's boats have been named Christine, in honor of his daughter. "I have a part time Captain, but I usually run the boat myself," he says. "I keep her behind my house in Ocean Reef along with our 53ft Hydra-Sports center console. We actually tow that behind the big boat. I may not have the biggest yacht but I have the biggest tender in the marina!"

"I've been running boats my whole life and I also fly jets," says Jim. "I like to go fast. My E88 wasn't a fast boat, but she wasn't slow. At first I was concerned about the speed with a large fast displacement boat like the FD85. But, when you look at the space you get with the FD85 — you have a spacious, modern, well-designed boat with an on-deck master and four big state-rooms below... well, I'm learning to put up with the slower speed."

With all that space and styling comes some serious performance in rough weather, as Jim and his wife experienced during one Bahamas crossing. "We had eight- to- ten-foot seas; it was some pretty nasty weather, and I was very pleased with how the boat handled. In 35 knots the boat did fantastic. Even my wife, who usually gets seasick said she was very comfortable under the circumstances."





DESTINATIONS
From their home in Ocean Reef, the Loomis family enjoys cruising to Nassau and The Bahamas or venturing to Nantucket in the summer months.

Q: How do you like to use your Horizon?

From their home in Ocean Reef, Florida, Jim and his wife take Christine to the Bahamas where they cruise the Exumas or visit Atlantis or, when the yacht is up in Avalon, New Jersey, Jim and his son will run it up to Nantucket to rendezvous with family during the summer months.

Jim says he enjoys just being out on the water with his family and grandkids. “We take turns with the Captain running the boat. I’m not big on entertaining, I just enjoy boating and being with family.” Jim says his entire family loves the space afforded by the FD85 and, with the 53-footer as a tender, there is plenty of opportunity for fishing and diving excursions.

“I LIKE MY BOAT NOW,” JIM SAYS OF THE OPEN BRIDGE CONFIGURATION ON THE FD85, “WHEN WE GO TO THE BAHAMAS WE OPEN IT UP TO ENJOY THE BREEZE. BUT HAVING THE SKYLounge ENCLOSED [SUCH AS IN THE FD87 SKYLINE] IN NASTY WEATHER WILL BE IDEAL.”

Q: What’s next?

Jim and his family have owned their FD85 for a little over a year but he’s already looking at his next Horizon and plans to stay in the FD Series. “I can’t go too big, though, or it won’t fit behind my home!” he says.

“The new FD87 has five big cabins for my family and guests. With this yacht there are a lot of new features, like the forward deck lounge that has refrigeration and storage as well as the open galley. That’s a big difference,” he says.

“I like my boat now,” Jim says of the Open Bridge configuration on the FD85, “When we go to the Bahamas we open it up to enjoy the breeze. But having the skylounge enclosed [in the FD87 Skyline] in nasty weather will be ideal.”

While experienced owners like Jim know that Horizon offers its clients great flexibility when it comes to customization, he said he hasn’t added any new features. “I usually take the yachts as they are. I think Horizon does a really good job. They take care of their owners.”

With the summer boating season just around the corner, you might catch a glimpse of Jim Loomis and his family enjoying the New England waters aboard their Horizon yacht, Christine. Thank you, Loomis family, for being an extension of our Horizon family. ➞

Horizon Shines: The Palm Beach Boat Show

The Horizon Yachts Showcase was the place to be during the 2019 Palm Beach Boat Show. For four sun-filled days, the Horizon stand was bustling with world-renown designers, international journalists, and prominent yacht brokers with clients in tow. The buzz centered around not one, but five fabulous Horizon yachts gracing the display, which included the brand new FD87, the unique V68, and the debuting FD77 model.



YACHTS ON DISPLAY

PC65 - *MUCHO GUSTO*

V68

FD77 OPEN BRIDGE

FD87 - *BELLA TU*

E88

Making its global debut, the FD77 is the latest model from the Cor D. Rover-designed Fast Displacement Series, which has seen tremendous success and record sales since it was first introduced just over two years ago. Customized for the U.S. market and offering the same impressive space and expanses of glass as the larger yachts in the FD Series, Hull One of the FD77 was noticed for its well-planned layout and option for crew if desired. The yacht's on-deck master stateroom, beach club, bridge deck bumpouts for docking, and pre-plumbed option for a Jacuzzi tub were among the numerous features that had visitors talking – and the response was overwhelming.



OVERHEARD
"The entire yachting industry is here!"



THESE PAGES
Two Horizon motor yachts - the FD87 *Bella Tu* (above) and the PC65 *Mucho Gusto* (left) were delivered to their owners during the festive four-day show.

OVERHEARD

"This feels like a 100-foot boat!"





OVERHEARD

"I love this beach club!"

**THESE PAGES**

Guests toured the yachts and enjoyed live music, hors d'oeuvres, cocktails and Taiwanese beer.

table on the aft deck, and sliding bow tables.

To add to the excitement, this yacht was delivered to her new owners on the second night of the show. Attended by the owners, Horizon's U.S. and Taiwanese management teams, journalists, yacht designers and special guests, the christening ceremony of the new *Bella Tu* was followed by a cocktail celebration featuring live music, passed hors d'oeuvres and specialty cocktails, including Taiwanese beer imported specifically for the occasion.

On the third evening of the show, another set of owners celebrated the christening of their new yacht at the Horizon display. The new PC65 – now named *Mucho Gusto* – is the second Horizon Power Catamaran for her owners. *Mucho Gusto* is the largest of the PC Series and features an advanced hull design that is the culmination of decades of catamaran hull development, tank testing and CFD analysis. The versatility of the PC65 will appeal to the seasoned yachtsman, and is available in either Open Flybridge or Skylounge versions with several layout and custom interior options.

Series designer J.C. Espinosa visited the Horizon showcase and, surveying the excitement from the attendees remarked, "Horizon's management's willingness to constantly update and improve their different models allows them to keep the designs fresh and attractive to the discerning buyer. Yet another proof of this is the completion of two brand new RP110s that are being delivered this month!"

Horizon preferred brokerage partner Yacht Connexion also had a showcase of pre-owned luxury Horizon yachts on display nearby, further demonstrating the depth of offerings and building strength that the award-winning Taiwanese builder provides. ➞

Hull Two of the new V68 model occupied the neighboring slip to the FD77 and caught the attention of attendees who noticed her spacious beach club, opening doors into the main deck and stylish use of glass on the superstructure. Designed by Jonathan Quinn Barnett, the V68 attracted the notice of many attendees who felt it offered the most amenities of a yacht in this size range, particularly the full-beam master stateroom. The attendees were further impressed when they learned of her efficient propulsion package and long-range cruising capabilities.

Docked in a prominent position alongside the entrance to Ramp 1, the latest FD87 captivated show attendees with her head-turning profile, impressive beach club and voluminous interior design. This is the first FD87 to feature a semi-walkaround side deck on the upper level and features a unique foredeck lounging area complete with refrigeration and an icemaker. As with every Horizon, this yacht showcases many owner-specified features for increased functionality, including a convertible dining table, hi/lo dining

Big Horizons And Big Sales: The Sanctuary Cove International Boat Show



Horizon Yacht Australia made a bold statement

at the annual Sanctuary Cove International Boat Show (SCIBS), hosting its largest and most extravagant showcase to date. Four stunning new builds as well as four brokerage Horizon yachts were on display during the show, which ran from May 23 – 26, 2019. The flagship display yacht was the new Horizon RP110 (*featured on page 24*), which, with a nearly 122ft LOA, was the largest Horizon yacht to ever grace the Australian coastline. The new RP110 was accompanied by two popular E75 motor-yacht models as well as the debuting Horizon FD77 Skyline, which sold quickly to an Australian buyer who saw the yacht at the show.

With an LOA of 121'10", the new Horizon RP110 was a hit at the show with visitors traveling from all over the country to tour this impressive build. This is the third Horizon built for her Australian owner and features numerous customizations. The custom yacht is equipped with twin MTU V16 2600hp engines, the latest state-of-the-art Black Box Furuno navigation package, an OctoPlex system, upgraded 440/20X stabilizers, a Yacht Controller, and a retractable hydraulic sunroof. Beneath the waterline, Horizon fitted nearly 30 blue underwater lights around the entire vessel, which create a mesmerizing glow when they light up the deep navy blue hull at night.

THIS PHOTO
Four diverse Horizon yachts, ranging from the E75 to an extended RP110, were featured within the showcase.

YACHTS ON DISPLAY

E75 (TWO MODELS)

FD77 SKYLINE

RP110 - THE LEGION



Making its global debut and quickly becoming a show favorite for all who attended SCIBS, the FD77 Skyline is one of the latest models from the acclaimed Cor D. Rover-designed Fast Displacement Series. Customized for the Australian market and offering the same impressive space as seen in the larger yachts in the FD Series, the FD77 Hull Two was noticed for its well-planned layout and option for crew if desired.



THIS PAGE

A Horizon owner celebrated his 70th birthday with us (left) while on the Saturday night Horizon Yachts Australia hosted its first annual dinner series (below).

The yacht's enclosed skylounge, on-deck master stateroom, beach club, bridge deck bump outs for docking,

and bold exterior design were among the numerous features that had visitors talking.

Appearing alongside these impressive luxury yachts were two Horizon E75 motor yachts – the most popular Horizon yacht model for the Australian market. Within an 18'6" beam, the E75's interior features increased volume and numerous lounging areas. Entertaining with family and friends is a pleasure thanks to the E75's creative foredeck seating area, exterior bar on the boat deck, and incredible aft deck offering luxurious, shaded relaxation. This is a yacht that defies size perception and provides the amenities and space of a far larger yacht within a stylish profile.

The 2019 SCIBS was one of the most successful shows the Horizon Yacht Australia team has seen in years, with resulting sales in both new and brokerage yachts – most notably the quick sale of the debuting FD77 Skyline. ➞



2019 Asia Boating Awards “Best Asian Yacht Builder” AGAIN!

Horizon Yachts is once again the recipient of the “Best Asian Yacht Builder” award. It is the yard’s 14th consecutive win at the annual Asia Boating Awards ceremony, which was held on April 10, 2019 in Singapore. Horizon has now been honored with this prestigious award 13 times. The top award of the evening, the title of “Best Asian Yacht Builder” is presented to one yacht builder in the Asia-Pacific region who has demonstrated “consistent, outstanding quality over the past year and who has the proven ability to expand in the market.” For Horizon, being recognized as the Best Asian Yacht Builder celebrates the company’s innovation and continued growth as a luxury yacht manufacturer, which is underscored by our dedication to building world-class yachts for clients around the globe.

“We are very proud to have received the ‘Best Asian Yacht Builder’ award again this year,” said CEO John Lu. “The development of Horizon’s cutting-edge products has set a benchmark in yacht building and design, and has

given us a strategic advantage over the competition.”

THIS PAGE

Horizon was once again honored as Best Asian Yacht Builder for 2019, an award the company has now received 13 times.

Organized by *Asia-Pacific Boating* magazine and *China Boating* magazine, the Asia Boating Awards are the most renowned yachting awards in Asia. ➡



—ON THE— CALENDAR



August

Sydney International Boat Show
Sydney, Australia
August 1 to 5, 2019

September

Cannes Yachting Festival
Cannes, France
September 10 to 15, 2019

Horizon Global Owner Rendezvous
Hamilton Island, Australia
September 19 to 22, 2019

Monaco Yacht Show
Monaco
September 25 to 28, 2019

October

Fort Lauderdale Int'l Boat Show
Fort Lauderdale, Florida
October 30 to November 3, 2019

December

NCHA Futura Semi-Finals & Finals
Fort Worth, Texas
December 3 to 7, 2019

January

Horizon Yachts Open House
Kaohsiung, Taiwan
January 14 to 16, 2020

The Seattle Boat Show
Seattle, Washington
January 24 to February 1, 2020

February

Miami International Boat Show
Miami, Florida
February 13 to 17, 2020

Horizon Yachts USA Open House
Fort Lauderdale, Florida
February 13 to 17, 2020

March

Palm Beach International Boat Show
Palm Beach, Florida
March 26 to 29, 2020

April - May

Sanctuary Cove Int'l Boat Show
Gold Coast, Australia
Dates TBD



Upcoming Boat Shows: Horizon Yachts Headed to Sydney, Cannes, and Monaco



Horizon's E and FD Series will represent at upcoming boat shows in Australia, France, and Monaco. The Horizon E75 motoryacht will entertain visitors to the Sydney International Boat Show August 1 – 5. A popular model for the Australian market, the E75 is designed for entertaining and features a creative foredeck seating area, exterior bar on the boat deck, and a spacious aft deck for shaded relaxation.

The brand new Horizon FD87 Skyline will be available for viewing in the Mediterranean, first at the Cannes Yachting Festival, September 10 – 15, followed the Monaco Yacht Show, September 25 – 28.

Designed for the European market and featuring a five-stateroom layout, the new FD87 Skyline boasts numerous innovative features, from an expansive foredeck lounging area to the fully equipped beach club. Large windows, an expansive beam and ingenious functionality make the FD87 Skyline yet another head-turner.

To make an appointment to view these yachts, please contact Horizon Yacht Australia at +61 7 5577 9009 or email sales@horizonyachtaus.com; or Horizon Yacht Europe at +34 971 673 508 or email tom@horizonyachteurope.com. ➡

THIS PHOTO
The newest FD87 Skyline will appear at the glittering Monaco Yacht Show September 25 – 28, 2019.



THIS PAGE
As with every Horizon build, customization is key. On this E75 (right photo) the yard incorporated an inviting foredeck seating area.



WHAT'S ON DISPLAY



Sydney International Boat Show

DATES: 1 – 5 AUGUST
LOCATION: DARLING HARBOUR, SYDNEY
BERTH NO: TBD
HORIZON ON DISPLAY: E75

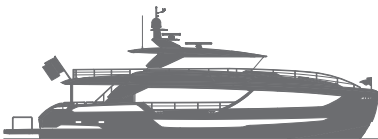

Cannes Yachting Festival

DATES: 10 – 15 SEPTEMBER
LOCATION: VIEUX PORT, CANNES
BERTH NO: SUPER YACHTS EXTENSION
HORIZON ON DISPLAY: FD87 SKYLINE

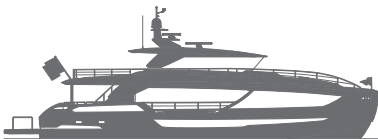

Monaco Yacht Show

DATES: 25 – 28 SEPTEMBER
LOCATION: PORT HERCULES, MONACO
BERTH NO: C25 QUAI CHICANE
HORIZON ON DISPLAY: FD87 SKYLINE

Destination Spotlight

HAMILTON ISLAND

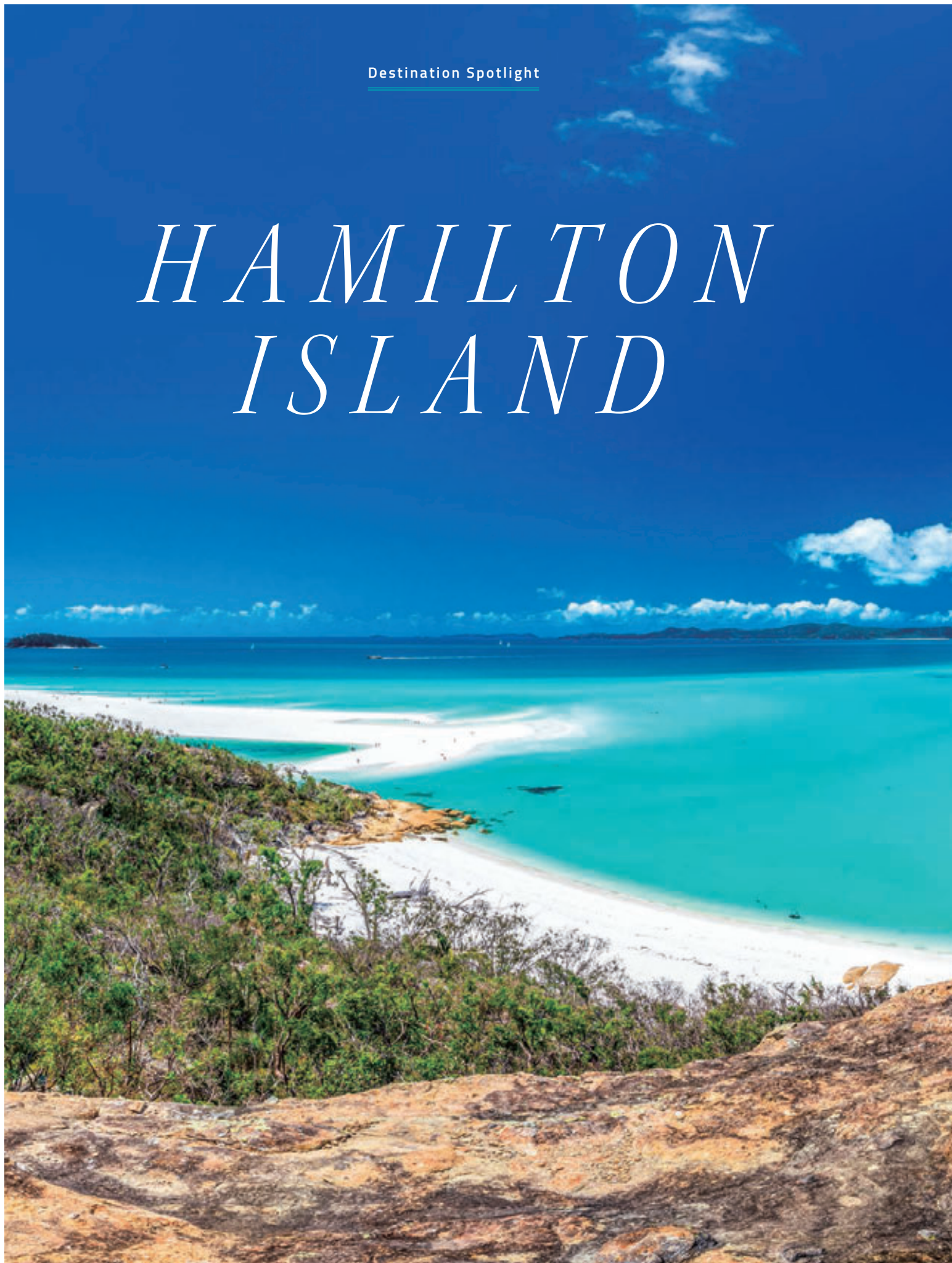



*The site of the upcoming Global Horizon Owner Rendezvous,
Hamilton Island is a magnificent island situated in the
heart of Australia's most breathtaking cruising destination.*



There is a destination so pure, so private ☒ and so luxurious ☒ you might be surprised to learn it exists. Yet it does. Nestled within Australia's Whitsunday Island group, Hamilton Island offers the ultimate escape for those who seek privacy and exclusivity. This largely uninhabited island neighboring the Great Barrier Reef acts as the country's most exclusive private resort, a unique hideaway offering breathtaking beaches coupled with high-end accommodations, dining, shopping, golf, and pure luxury.

Hamilton Island History

The privately owned Hamilton Island, known as the gateway to the Whitsunday Islands and the Great Barrier Reef, was "discovered" in the mid 1970s by Australian tourism entrepreneur Keith Williams as he cruised the Whitsundays on his motor yacht. By the early 1980s, Williams had built a commercial airport, harbor and small resort in what would become Australia's premier tropical island resort destination.

Yet another yachtsman caught sight of the development on the island from the deck of his motor yacht, made a mental note, and ended up purchasing the island in 2003. That yachtsman was famed winemaker Bob Oatley, who made a significant investment into creating a world-class destination and whose family remains in possession of the island to this day.

Great Barrier Reef

One of the great wonders of the world, the Great Barrier Reef is the very picture of natural splendor, where color and life collide in brilliant harmony in a magnificent undersea world. Comprising more than 3,000 individual reef systems and covering some 135,000 square miles, the Great Barrier Reef is home to the most intricate and varied expanse of living corals in the world. Ideal for diving and snorkeling, this natural feat of engineering dates back some 450 million years and is home to more than 1,500 species of fish and myriad wildlife, including sea turtles, giant clams, dolphins and humpback whales. It is one of the world's best playgrounds, waiting to be discovered.

Hamilton Island Beaches

Boasting some of the most breathtaking beaches in the world, Hamilton Island is home to the world-famous Whitehaven Beach. Recognized as the top beach in Australia, this expansive, unspoiled stretch is comprised of sand so pure it has been deemed just a fraction shy of pure silica. Geologists have theorized that the drift systems in this part of the world serve to purify the powder-like grains of quartz to the point of being able to be used in the fine manufacturing process of binocular lenses. Punctuated by the occasional beach enthusiast or yacht, the beach remains largely isolated, allowing you to indulge in your own private paradise and luxuriating in the warm turquoise water that surrounds it.

Hamilton Island Activities

From snorkeling to shopping, deep-sea fishing to golfing, meeting a cute koala bear to taking an off-road adventure tour, Hamilton Island offers a world of exploration and relaxation. On this car-less island, a Buggy Rally is a great way for a group of people to get to know this beautiful destination, while answering trivia questions about the area along the way. Hamilton Island Golf Club offers a scenic par 71, 18-hole championship course and clubhouse on neighboring Dent Island where non-golfers alike can enjoy the views with a leisurely luncheon overlooking the blue water below. At the end of each excitement-filled day, toast to a spectacular sunset from any of the island's amazing photo spots and enjoy the life of Australian luxury. ➞

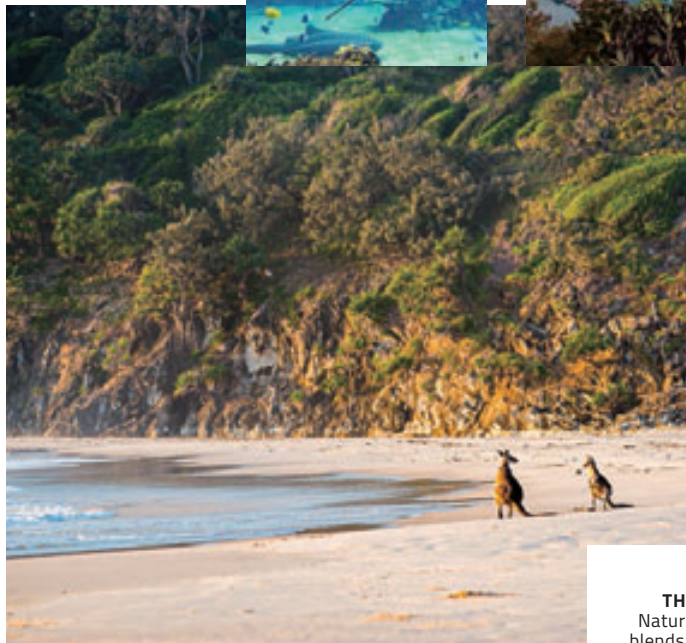
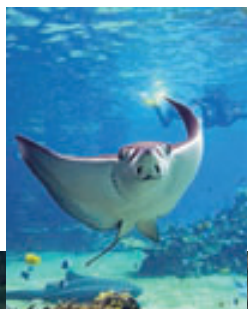

THIS PAGE
Natural splendor
blends with luxury.

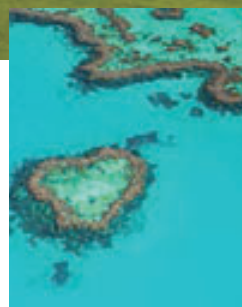

IMAGES © / ADOBE STOCK

FROM SNORKELING TO SHOPPING, DEEP-SEA FISHING TO GOLFING,
KOALA BEARS TO OFF-ROAD ADVENTURE TOURS, HAMILTON
ISLAND OFFERS A WORLD OF EXPLORATION AND RELAXATION.

Brand New Inventory



Your dream yacht is waiting
so you don't have to...

NOW IN THE US



HORIZON E88 MOTORYACHT

- Enclosed skylounge design
- Beach club with Hi/Lo platform
- Lounge seating on boat deck
- 4 ensuite staterooms + crew
- Zero Speed stabilizers + thrusters
- Twin MAN 1800HP engines

E SERIES: E56 // E56XO // E62 // E75 // E78 // E84 // **E88** // E98

NOW IN THE US



HORIZON FD77 MOTORYACHT

- New design for FD Series
- Beach club with Hi/Lo platform
- Spacious 23' beam
- 4 ensuite staterooms + crew
- Open flybridge / fixed windscreen
- Twin MAN V8 1200HP engines

FD SERIES: FD70 // **FD77** // FD85 // FD87 // FD102 // FD125

HORIZON FD87 SKYLINE MOTORYACHT

- Enclosed bridge (Skyline) version
- Beach club with Hi/Lo platform
- Voluminous 23' 3" beam
- On-deck master + 4 guest + crew
- Semi-walkaround deck
- Twin MTU 1600HP engines

FD SERIES: FD70 // FD77 // FD85 // **FD87** // FD102 // FD125

IN US FALL 2019



NOW IN AUSTRALIA



HORIZON V81 MOTORYACHT

- Custom-built enclosed skylounge
- Long-range capabilities
- Large foredeck seating + sunpads
- 3 spacious ensuite staterooms
- Generous 20' 6" beam
- Twin CAT C18A 1150HP engines

V SERIES: V68 // V72 // V80 // **V81**

HORIZON RP110 SUPERYACHT

- Voluminous 25' beam
- Beach club with Hi/Lo platform
- 6' island-friendly draft
- 4 ensuite staterooms + crew
- Zero Speed stabilizers + thrusters
- Twin CAT C32Z 1900HP engines

RP SERIES: RP97 // **RP110** // RP120

NOW IN EUROPE



NOW IN THE US



HORIZON V68 MOTORYACHT

- Beach club with Hi/Lo platform
- Open flybridge with day head
- Large foredeck seating + sunpads
- 3 spacious ensuite staterooms
- Zero Speed stabilizers + thrusters
- Twin CAT C18A 1136HP engines

V SERIES: **V68** // V72 // V80

USA
+1 561 721 4850
horizonyachtusa.com

EUROPE
+34 971 673 508
horizonyachteurope.com

AUSTRALIA
+61 7 5577 9009
horizonyachtaus.com

HORIZON
WORLD CLASS YACHTS



HORIZON

Network of Operations



Horizon Shipyard

SINCE 1987
452,080 SQFT

FEATURES

YACHTS UP TO 150FT LOA
INTERIOR DESIGN CENTER



Atech Composites

SINCE 2000
249,070 SQFT

FEATURES

COMPOSITE LAB
TECHNOLOGY SHOWROOM



Vision Shipyard

SINCE 2001
161,460 SQFT

FEATURES

YACHTS UP TO 80FT LOA
INTERIOR DESIGN CENTER



Premier Shipyard

SINCE 2005
258,330 SQFT

FEATURES

DELIVERY CENTER
REFIT SERVICES



Horizon City Marina

SINCE 2014
YACHTS UP TO 200FT

FEATURES

FULL SERVICE MARINA
CLUBHOUSE AND RESTAURANT

Worldwide Distribution Network



Horizon's Premier Service & Refit Center

- Annual Scheduled Maintenance
- Interior Modifications / Painting
- Hull Structure Modifications
- Naval Architecture Services
- Haul Out / Class Approval

A TALENTED NAVAL ARCHITECTURE TEAM AND A CONVENIENT MARINA LOCATION.

The Horizon Refit Center has the capacity to accommodate 100ft-plus (30m+) yachts for maintenance, repair, and refit services. The Refit Center encompasses 656ft (200m) of waterfront property on Taiwan's Kaohsiung Harbor and is equipped with a 200ft (60m) x 45ft (14m) floating dry dock with 500-ton lifting capacity and 26,000sqft (24,000sqm) of private yard space.



HORIZON

+886 7 860 770
info@horizonyacht.com

THE HORIZON FLEET

Our Series Defined



PC52



PC60



PC65



PC74

PC
SERIES

Elegant Design, Luxurious Amenities, Ultra Comfortable Cruising



EP69



EP150

EP
SERIES

Designed to Inspire, Built to Explore



FD70



FD77



FD85

FD
SERIES

Innovation, Efficiency, Style, and Space



E56



E56XO



E62



E75

E
SERIES

Seaworthy, Sporty, Something for Everyone



V68



V72



V80

V

SERIES

Timeless, Versatile, Customizable



RP97



RP110



RP120

RP

SERIES

Multi-Functional Exterior Areas and Superyacht Space



P110



P140

P

SERIES

Superyacht Styling, Fully Customized Build



FD87



FD102



FD125



E78



E84



E88



E98

Coming January 2020

FD70



Four staterooms. On-deck master. Beach club. Owner operation.

Yes, you can have it all. Taking its place at the entrance of a series known for unparalleled volume, innovative functionality and intelligent layouts, the FD70 is a remarkable achievement in design and naval architecture. 2020 delivery slots available now. ➡

GOLD ANCHOR MARINA

WORLD CLASS AMENITIES

WATERFRONT DINING

EXPERIENCE CITY LIFE

HORIZON CITY MARINA

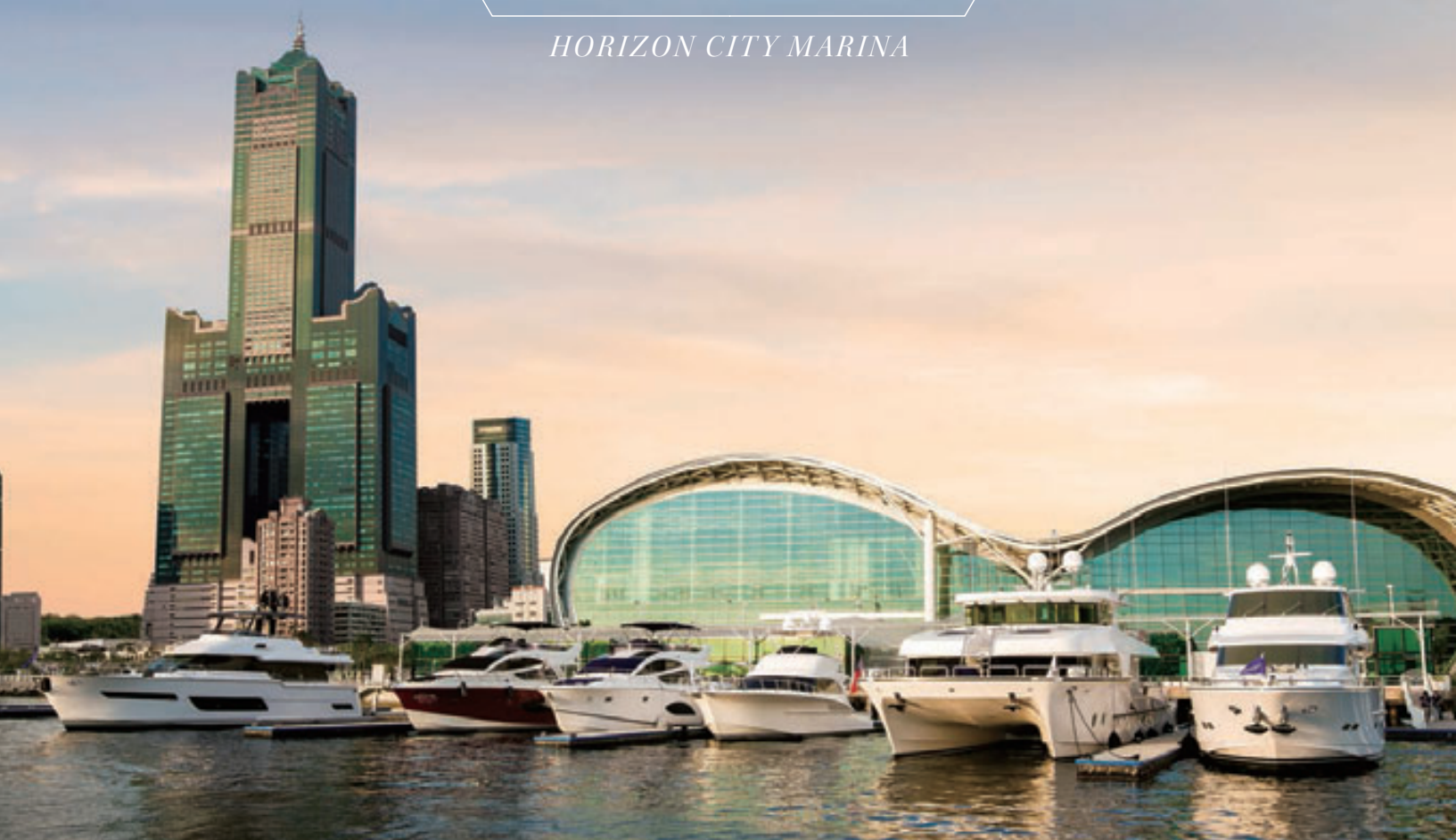

HORIZON
HORIZON CITY MARINA

A GOLD ANCHOR MARINA, A GATEWAY TO LUXURY.

The world class Horizon City Marina accommodates yachts up to 200 feet (60m) in 12 berths and alongside 1,100 feet of environmentally-friendly floating docks. Enjoy complete yachting services and amenities in Asia's up and coming leisure destination.

+886 963 713 993 hcm.horizonyacht.com



DEFINE YOUR HORIZON

It's time we took a bow...



Since debuting the first FD Series motoryacht featuring the High Performance Piercing Bow and hull design, we have answered the market's demand for interior space, superyacht amenities, and stability, resulting in 15 orders and the creation of 5 models in just 3 years. With great success, however, comes great humility and gratitude. This accomplishment is a credit to our employees and the owners and designers who have worked tirelessly and pushed boundaries to drive exceptional results. Join us in taking a bow in this collective achievement.



horizonyacht.com