

# P SERIES

  
**HORIZON**  
WORLD CLASS YACHTS





**ELEGANT AND LUXURIOUS**

Horizon's leading advanced composites construction technology and techniques form the foundation of the P Series. Exuding style and luxury, the P Series yacht provides safe, comfortable cruising wherever your travels may take you.



# *Defining the P Series*

*LUXURY*

The P Series defines superyacht living, with a tri-deck design and ample beam for a spacious interior and exterior.

*UNIQUE*

Within this multi-level yacht, an owner can incorporate a movie theater, spa, beach club, and the accommodations layout of their choice.

*CLASSY*

Built with the latest advanced composite construction methods, the P Series yacht can be built to meet DNV classification standards.



# Current Models

## SUPERYACHT LIVING WITHIN AN AWARD-WINNING DESIGN

This fully-customizable series of tri-deck superyachts offers owners the ability to create the layout of their dreams with the guidance and expertise of Horizon’s industry-leading design and build team.

2



Style, Space, Amenities

P110



Three Levels of Luxury

P130

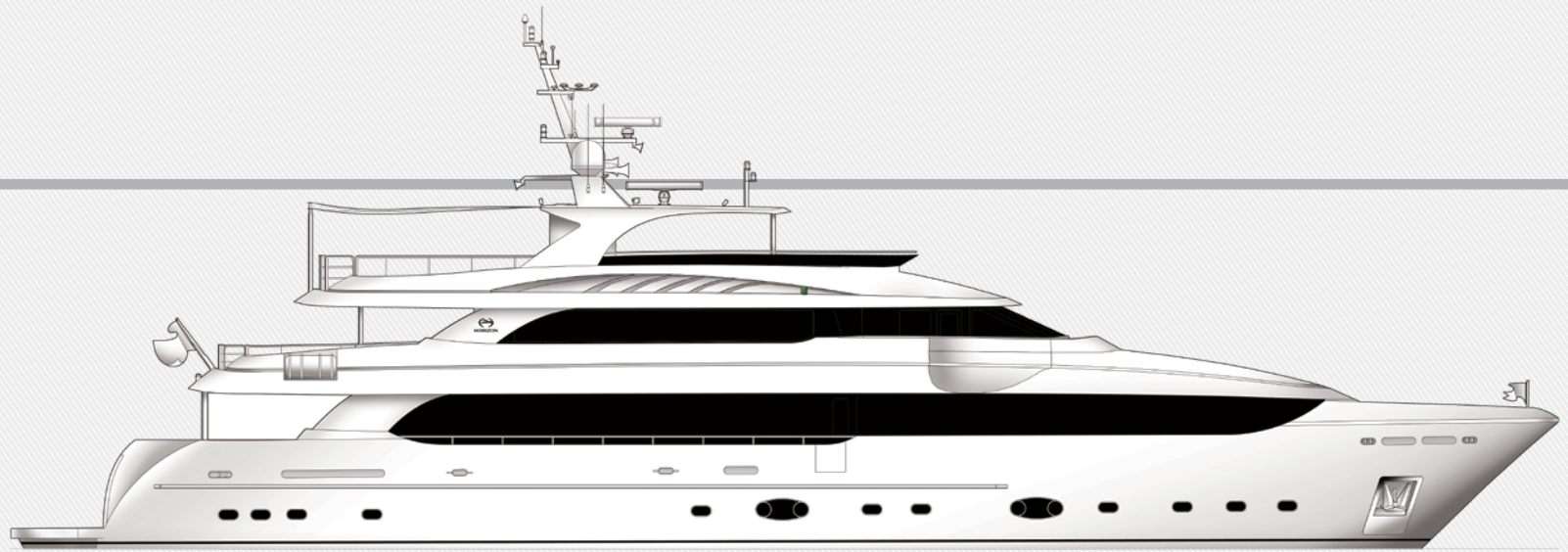

A Collaboration in Innovation

P140



An aerial, high-angle photograph of a white yacht named 'ANTITHESIS' moving through dark, choppy water. The yacht is viewed from the side and slightly from behind, showing its sleek, modern design. It has multiple decks, including a large upper deck with a curved structure and a lower deck with a circular hot tub. The name 'ANTITHESIS' is printed in bold, black capital letters on the side of the hull. The water is dark with white foam from the yacht's wake. The overall tone is dramatic and high-contrast.

# *Models & Configurations*

ANTITHESIS



# P110

*Style, Space, Amenities*

## A MASTERPEICE ON THE SEA.

The Horizon P110 is a world-class tri-deck yacht designed for those seeking the ultimate cruising experience.

Her 24ft (7.3m) beam and extended length provide a four-stateroom layout with additional crew quarters

that is spacious, functional and nothing short of luxurious. Offering a skylounge as well as a large flybridge,

this yacht allows an array of custom features and design options that combine to create a

tri-deck 110 that rivals 120ft (36m) yachts in design and function.







Main Salon



**THESE PAGES**  
This P110 features a rich dark walnut interior within which an open-plan main salon and dining area flow forward into a spacious galley with a country kitchen dinette.







VIP Stateroom



Full-Beam Master



**THESE PAGES**  
The P110 boasts spacious deck areas as well as a flybridge, which can be fitted with a Jacuzzi tub or a dining table.



Flybridge

**Sit back, relax, enjoy  
the journey.**



Main Deck Aft





Bridge Deck





# P110 Specifications and Layout

L.O.A.	110' (33.53m)
L.W.L.	95' 5" (29.08m)
Beam	23' 6" (7.16m)
Draft (half load)	6' 3" (1.91m)
Displacement (half load)	269,400lbs (122.2 tons)
Fuel Capacity	4,200 US gals (16,000ltrs)
Fresh Water Capacity	800 US gals (3,000ltrs)
Engines	Twin CAT C32A 1,600hp
Generators	Twin Onan 40kW (50Hz) or Twin Onan 40kW (60Hz)

## CUSTOMIZATION CAPABILITIES

Within its nearly 24ft beam, the P110 provides a palette upon which the customer can create a personalized superyacht experience.

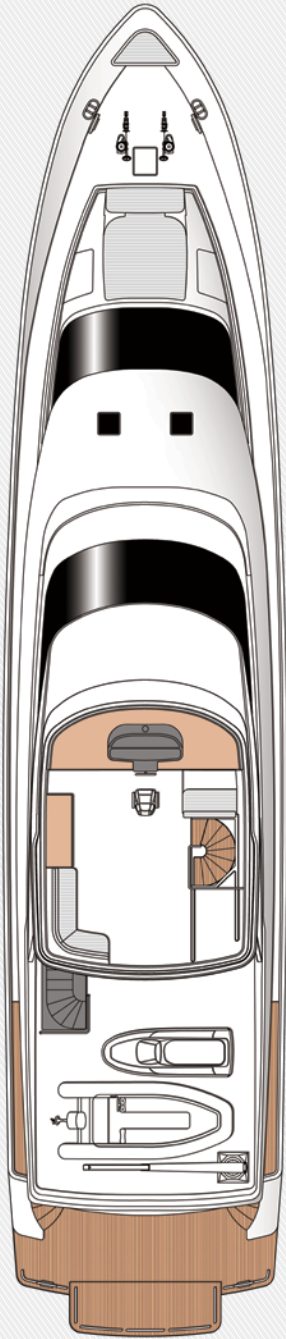
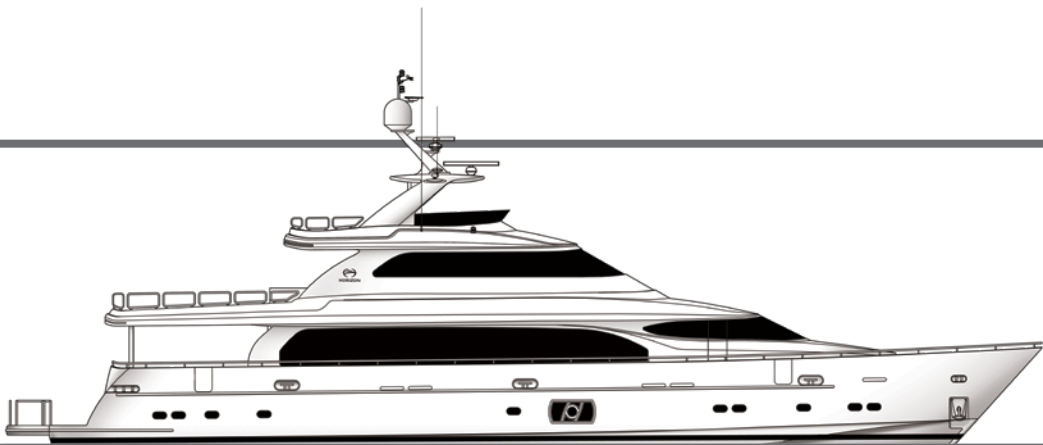

FLYBRIDGE

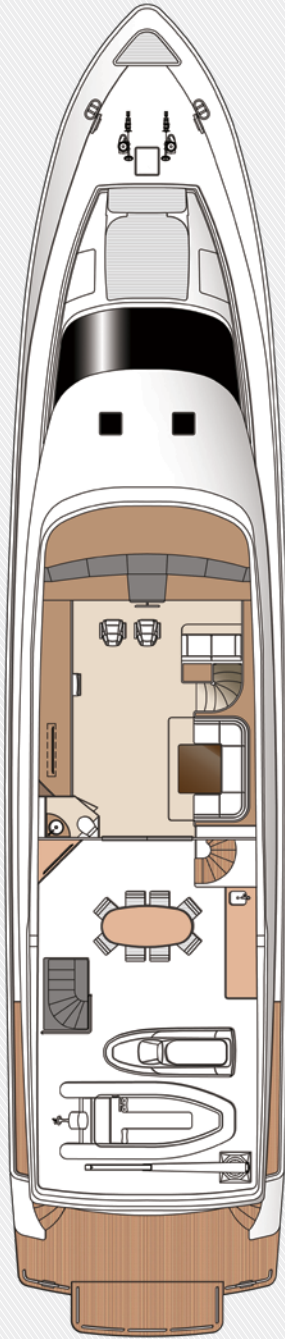

BRIDGE DECK

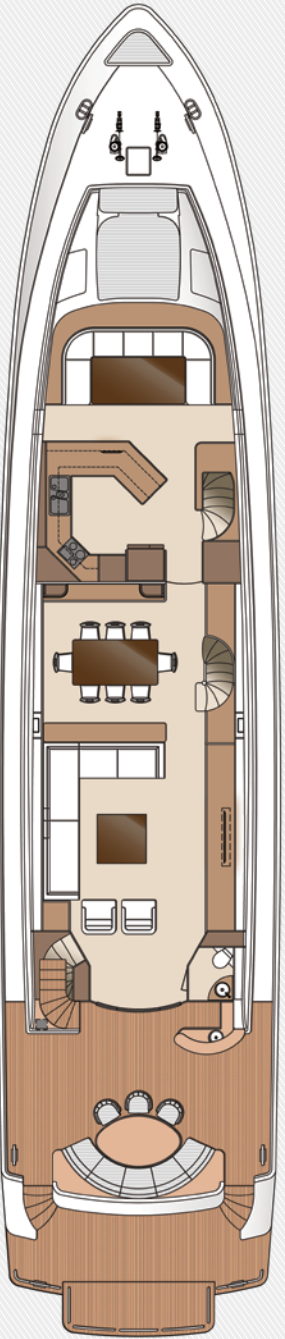

MAIN DECK

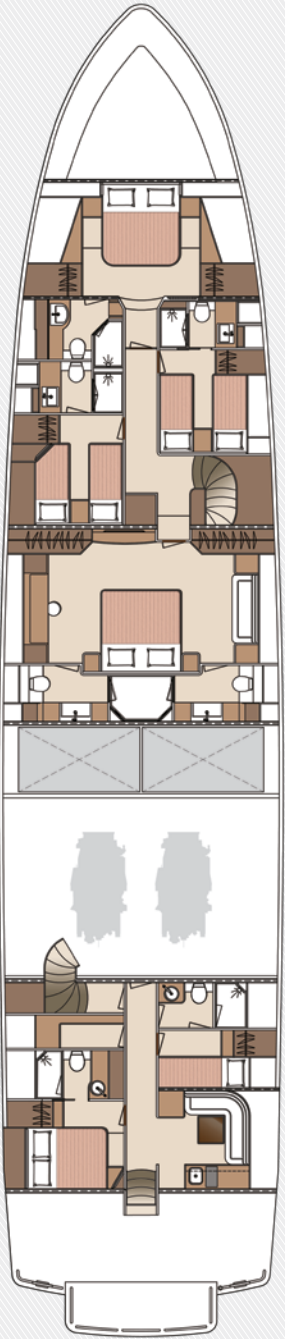

LOWER DECK



# P130

*Three Levels of Luxury*

## **BUILT TO SUIT YOUR DREAMS.**

The award-winning P130 model is a proven platform upon which an owner can design a fully custom layout.

Built to meet full DNV Class Certification and MCA compliance, each P130 features a flybridge with dual wingstations, a full-beam skylounge and spacious salon, five staterooms with a main-deck master, and full crew accommodations with either transom crew space or a transom garage plan.

Contemporary and capable yet timeless and efficient, the tri-deck P130 offers a comfortable and luxurious yachting experience.





# Miss Rose

At an overall length of 132 feet, the multiple award-winning *Miss Rose* is the first Horizon P130.

Completed in 2008, she held the record as the largest single-infused hull via the proprietary SCRIMP (Seamanns Composite Resin Infusion Molding Process) in the world for more than 10 years. The designs by Florida-based stylist J.C. Espinosa complemented the P130 model's naval architecture and engineering plans and gave *Miss Rose* a refined yet modern look.

Featuring two full-beam master staterooms and three flexible-layout staterooms below deck, she features a luxurious and spacious interior coupled with plentiful exterior spaces.







Main Salon

**THESE PAGES**  
*Miss Rose* features a formal yet multifunctional interior augmented by large windows throughout.





**RIGHT**  
*Miss Rose* was designed  
 with a professional  
 commercial galley on  
 the main deck.



Bridge Deck Master



Main Deck Master





**THESE PAGES**

The outdoor spaces were designed to facilitate relaxation on the sea.



**alfresco life under  
the sun or stars**

Flybridge



# P130 Miss Rose Specifications and Layout

L.O.A.	132' (40.23m)
L.W.L.	114' (34.76m)
Beam	26' 2" (8m)
Draft (half load)	7' 4" (2.24m)
Displacement (half load)	573,200lbs (260 tons)
Fuel Capacity	11,000 US gals (41,600ltrs)
Fresh Water Capacity	1,400 US gals (5,300ltrs)
Engines	Twin CAT C32A 1,800hp
Generators	Twin Onan 80kW (60Hz)

## CUSTOMIZATION CAPABILITIES

As the largest yacht built in 2008 in Taiwan, *Miss Rose* was the result of true international cooperation. Her styling and interior design each came from Florida-based J.C Espinosa while naval architecture was overseen by Greg Marshall, based in Canada. Her intricately designed interior décor is also worthwhile to mention – with two large master staterooms - one on the main deck and the other on the bridge deck - and 13 wood veneers and 11 marbles incorporated throughout.

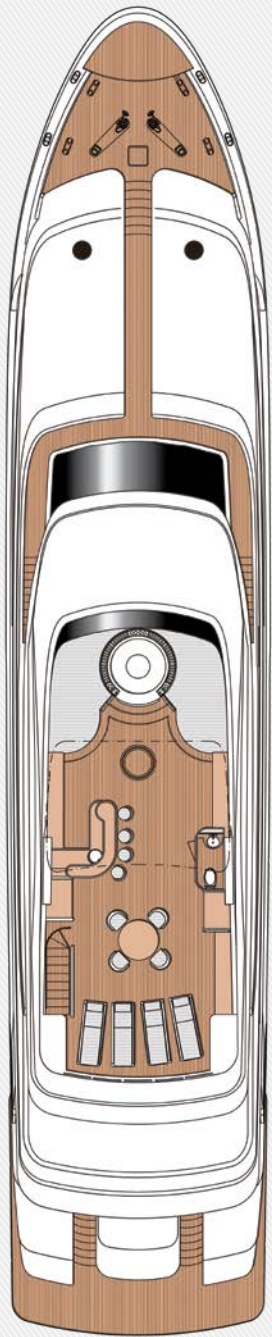

SUN DECK

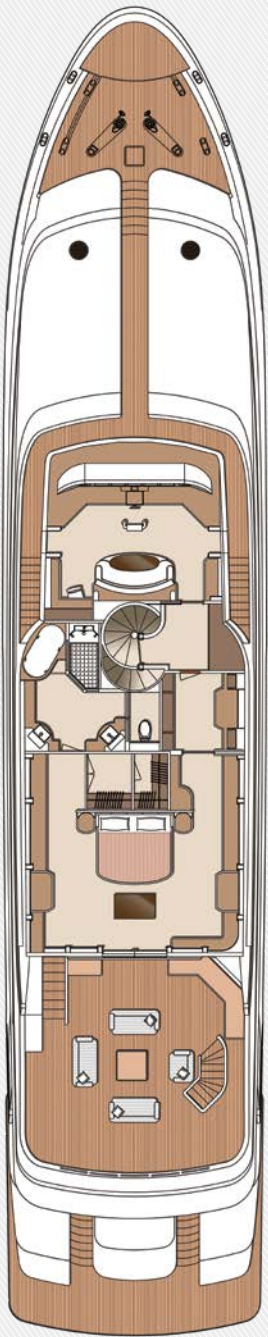

BRIDGE DECK

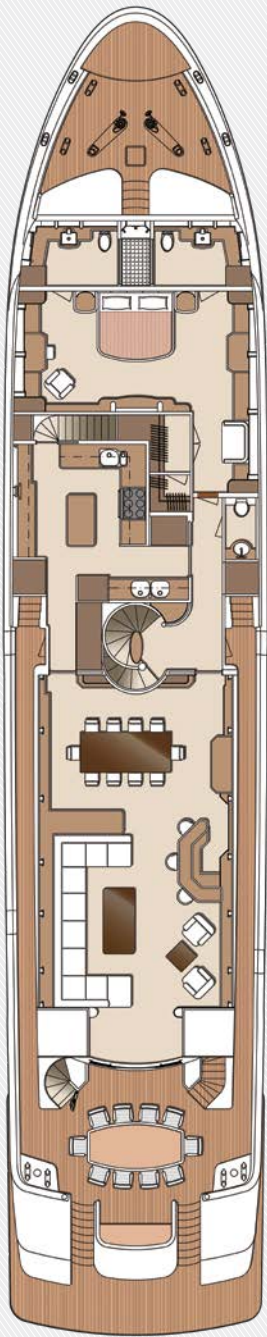

MAIN DECK

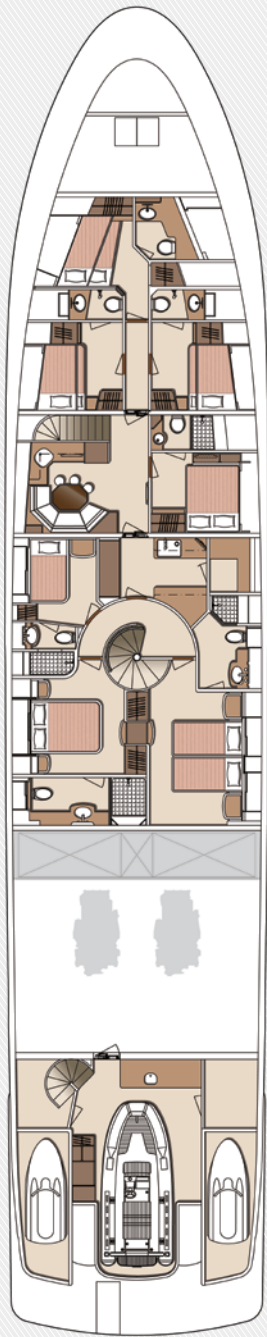

LOWER DECK



# After You

The second Horizon P130, *After You* was completed in 2008. Designed in collaboration with Gregory C. Marshall and Espinosa Yacht Design, *After You* boasts a layout that emphasizes open spaces and features six staterooms, including an on-deck master and spacious VIP suite. Equipped with Twin CAT C32A 1,800hp engines, *After You* proved her seaworthiness during her sea trials, which took place two days after a typhoon in extremely challenging conditions.







Skylounge

**THESE PAGES**

*After You's* sophisticated interior was designed with entertainment in mind, with plentiful areas for relaxation throughout the tri-deck layout.



Main Salon





Pilothouse



Master Stateroom



Fwd VIP Stateroom







Sun Deck



**sun, fun  
and sea breeze**





# P130 After You Specifications and Layout

L.O.A.	130' (39.62m)
L.W.L.	114' (34.76m)
Beam	26' 2" (8m)
Draft (half load)	7' 4" (2.24m)
Displacement (half load)	544,540lbs (247 tons)
Fuel Capacity	11,000 US gals (41,600ltrs)
Fresh Water Capacity	1,400 US gals (5,300ltrs)
Engines	Twin CAT C32A 1,800hp
Generators	Twin Onan 65kW (60Hz)

## CUSTOMIZATION CAPABILITIES

“After You is a gentleman’s club that can

carry you to the farthest reaches of an

empire in grand style,” said *Yachting Magazine*.

The “club” theme lends itself well

to facilitating multi-generational

entertainment throughout the spacious,

six-stateroom layout.

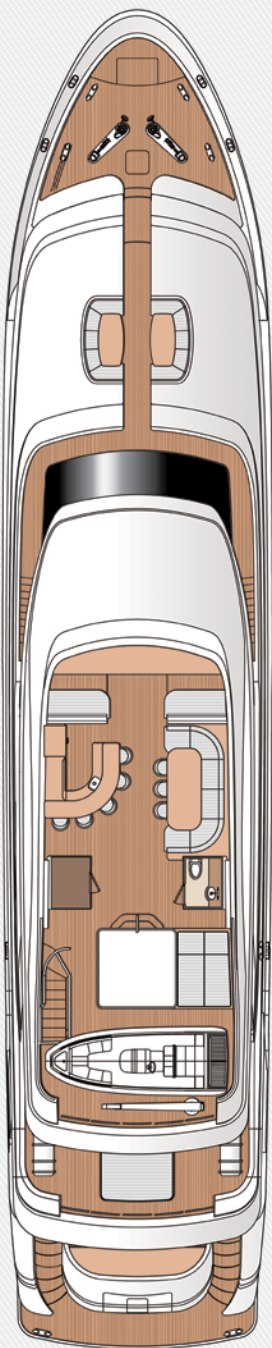

SUN DECK

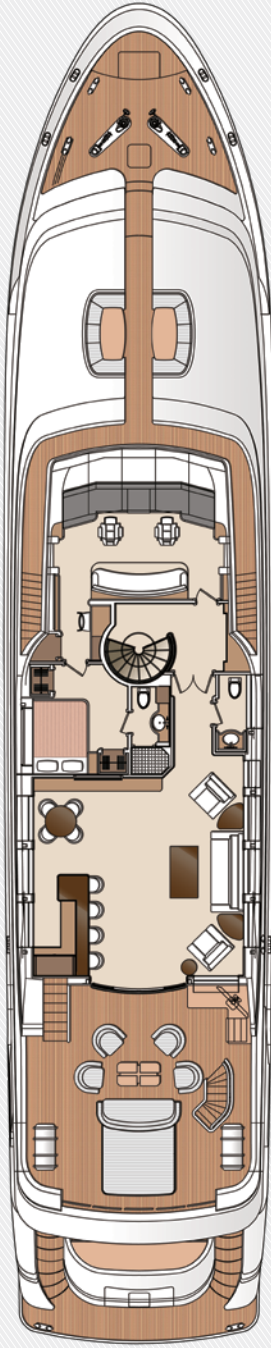

BRIDGE DECK

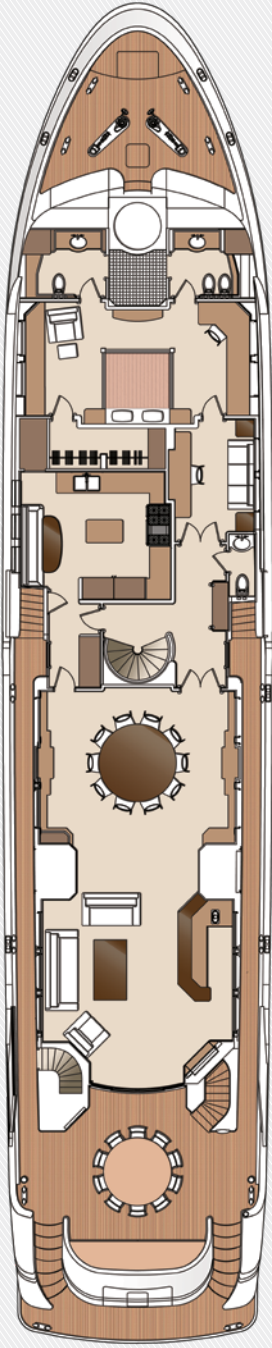

MAIN DECK

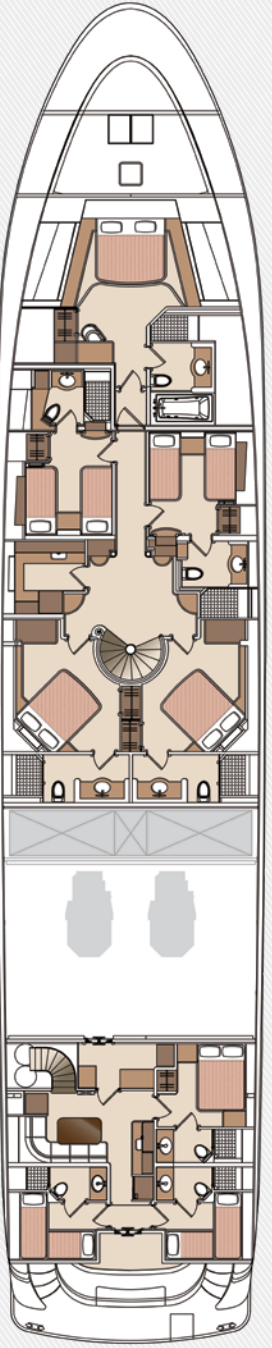

LOWER DECK



# Bikini Queen 2

"Acres of deck space" is how one publication described the expansive entertaining areas aboard *Bikini Queen 2*, the 135ft (41m) yacht built by Horizon. The bright and modern interior design boasts a 26ft (8m) beam and is a joint collaboration between Horizon, the owner and interior designer Claudia Drettman, while the external lines and styling retain the classic look by J.C. Espinosa. Delivered to her owners in 2009, *Bikini Queen 2* features a full-beam VIP stateroom amidships on the bridge deck, a full-beam master on the main deck, and four multi-functional cabins on the lower deck.







Main Salon

**THESE PAGES**

Modern luxury pervades the overall design on board. A mix of warm, neutral colors and soft textured fabrics make the interior areas relaxing and homey.



Skylounge





Guest Room/Gym



On-Deck Master





**luxury without limits**



# P130 Bikini Queen 2 *Specifications and Layout*

L.O.A.	135' (41.16m)
L.W.L.	121' 4" (36.98m)
Beam	26' 2" (8m)
Draft (half load)	7' 4" (2.25m)
Displacement (half load)	641,540lbs (291 tons)
Fuel Capacity	11,600 US gals (43,900ltrs)
Fresh Water Capacity	1,400 US gals (5,300ltrs)
Engines	Twin MTU 8V 4000 M75 1,550hp
Generators	Twin CAT 86kW (50Hz)

## CUSTOMIZATION CAPABILITIES

Born to entertain, *Bikini Queen 2* was designed with numerous areas for relaxation as well as two large spaces dedicated to toy storage.

The owners also specified a unique interior lighting package that blends well with the soft-colored woods to both brighten and enhance the spaciousness of the high volume interior.

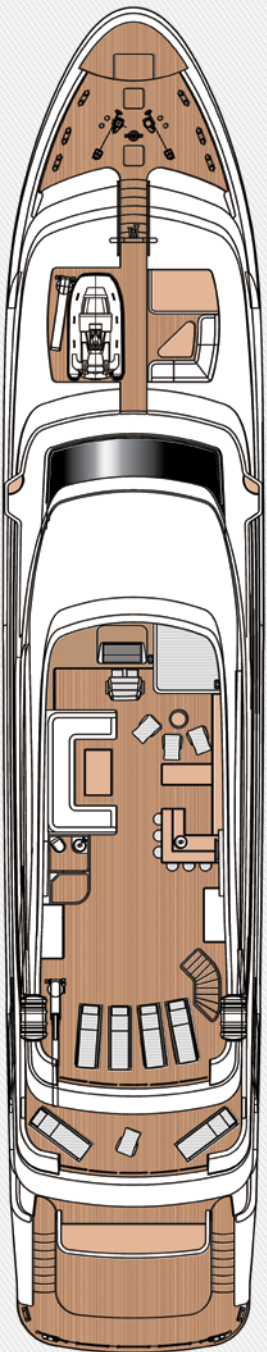

SUN DECK

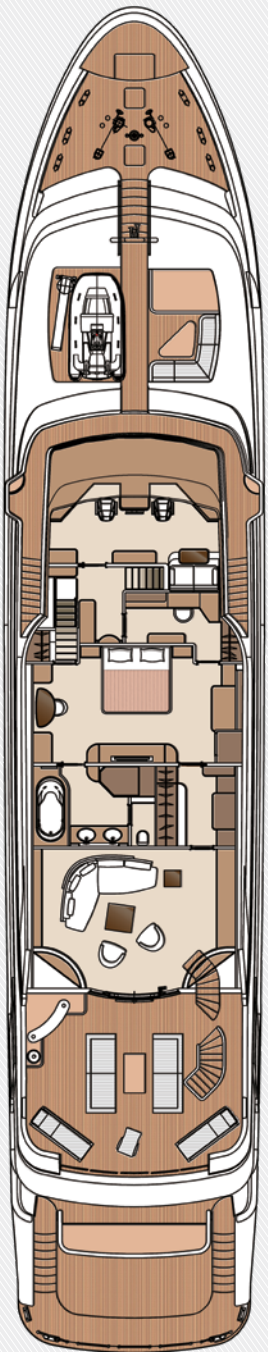

BRIDGE DECK

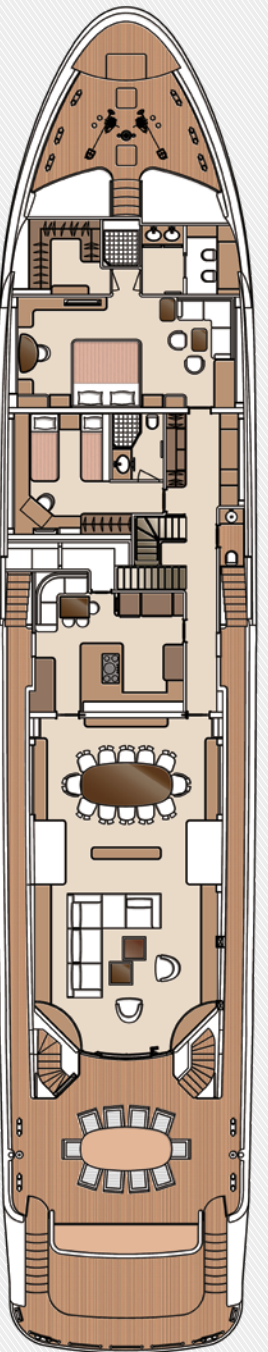

MAIN DECK

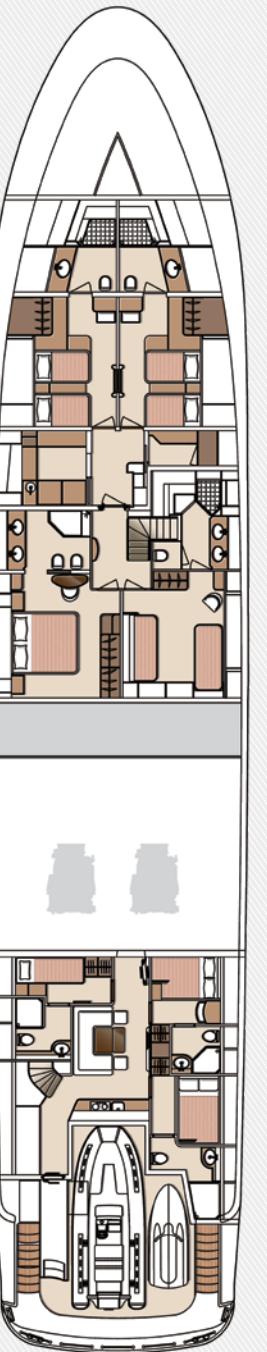

LOWER DECK



# Antithesis

*Antithesis* is a 136ft (41.45m) luxury motor yacht completed in 2009. For this build, Horizon switched from polyester resin to vinylester for the structural elements, including the hull, topsides and superstructure, as vinylester has shown to better resist osmotic blistering. *Antithesis* was also tested extensively to exceed the damage and stability requirements of the IMO HSC2000. The J.C. Espinosa/Greg Marshall styling and design of *Antithesis* is further improved by efficiency-minded details such as low-level LED lighting throughout, large props with small shafting angles, fuel filling stations with overflow alarms, IMO-approved water treatment and water-treated stern bearings.







#### THESE PAGES

*Antithesis* was designed with a unique low-level LED interior lighting design package.



Main Salon





Pilothouse



Master Stateroom



**THESE PAGES**  
Built for entertainment and relaxation, *Antithesis* accommodated ten guests in a full-beam, on-deck master and five well-appointed guest staterooms on the lower deck.



VIP Stateroom



pioneering  
yacht construction





# P130 Antithesis *Specifications and Layout*

L.O.A.	136' (41.45m)
L.W.L.	123' 4" (36.10m)
Beam	26' 2" (8m)
Draft (half load)	7' 4" (2.24m)
Displacement (half load)	504,860lbs (229 tons)
Fuel Capacity	11,000 US gals (41,600ltrs)
Fresh Water Capacity	1,400 US gals (5,300ltrs)
Engines	Twin MTU 8V 4000 M70 1,550hp
Generators	Twin Onan 65kW (60Hz)

## CUSTOMIZATION CAPABILITIES

The owner was first drawn to Horizon after seeing the award-winning P130 *Miss Rose*, after which he visited Horizon's shipyard and witnessed the quality of the P130 *After You*.

The owner and his wife incorporated numerous customizations throughout the yacht, particularly in the galley layout, which was designed to meet their needs as avid cooks.

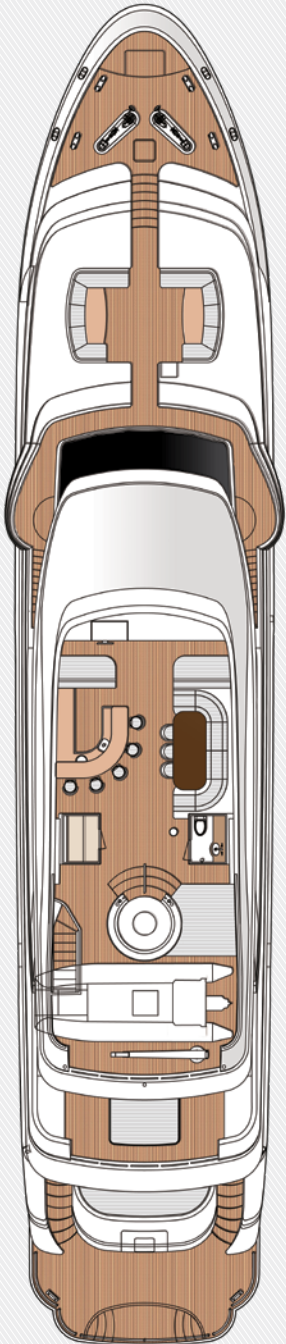

SUN DECK

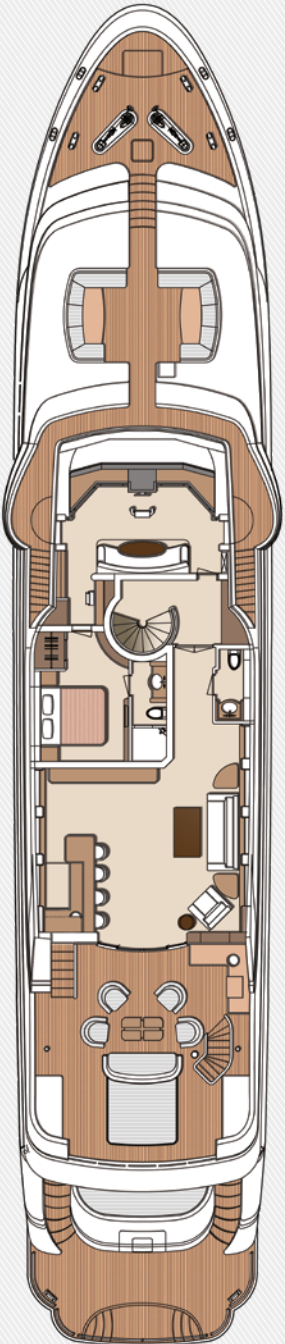

BRIDGE DECK

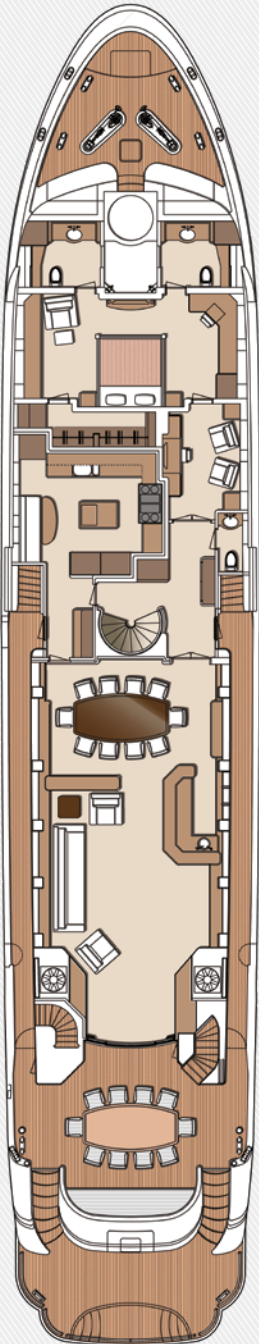

MAIN DECK

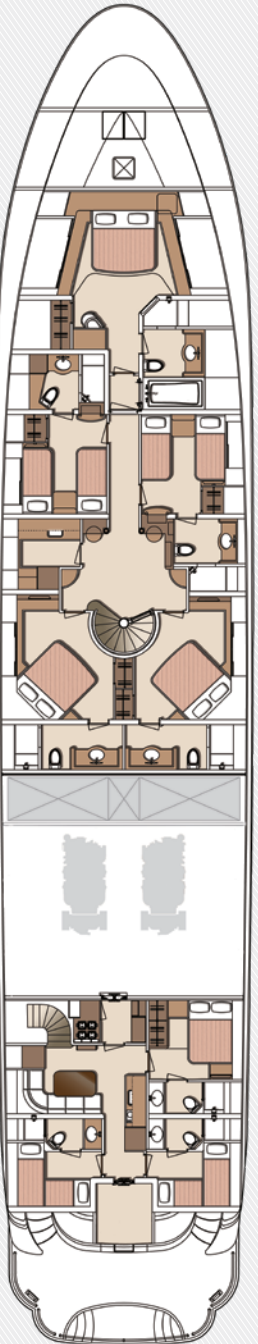

LOWER DECK



# Angara

Delivered in 2011, the 136ft (41m) *Angara* is the fifth P130 model built with dual DNV and MCA certification.

Named after the longest river in Russia, *Angara* was custom built to suit her owner and his young family.

*Angara* features a traditional layout designed by J.C. Espinosa, which includes a full-beam,

on-deck master stateroom and four additional staterooms below deck.

Powered by twin CAT C32 1,800hp engines, she achieves a maximum speed of

16.5 knots when fully loaded. At a 12-knot cruise, the fuel consumption of

this award-winning yacht is less than 130 liters per hour.







Main Salon



**superyacht life.**  
**superior comfort**



Skylounge





**THESE PAGES**

Configured with a full-beam, main-deck master suite and four guest staterooms on the lower deck, *Angara* can comfortably accommodate a maximum of thirteen guests.



VIP Stateroom



On-Deck Master







# P130 Angara Specifications and Layout

L.O.A.	136' (41.45m)
L.W.L.	118' 2" (36.02m)
Beam	26' 2" (8m)
Draft (half load)	6' 11" (2.12m)
Displacement (half load)	493,830lbs (224 tons)
Fuel Capacity	11,000 US gals (41,600ltrs)
Fresh Water Capacity	1,400 US gals (5,300ltrs)
Engines	Twin CAT C32A 1,800hp
Generators	Twin CAT 86kW (50Hz)



## CUSTOMIZATION CAPABILITIES

During the fitting out process, the owner made two short visits to the shipyard to review the design and discuss construction details. For his one-year-old daughter, Horizon engineered safety railings without gaps and installed protection doors to keep her away from the upper deck. For his teenage son, the owner requested the latest gaming and entertainment system.

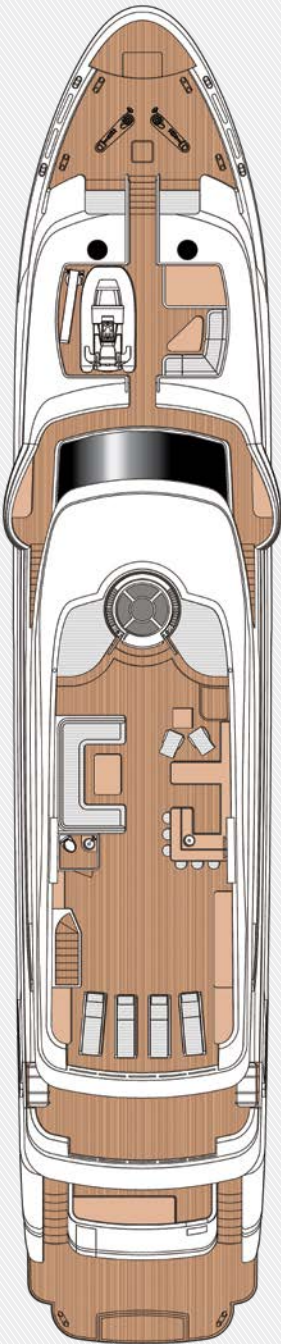

SUN DECK



BRIDGE DECK

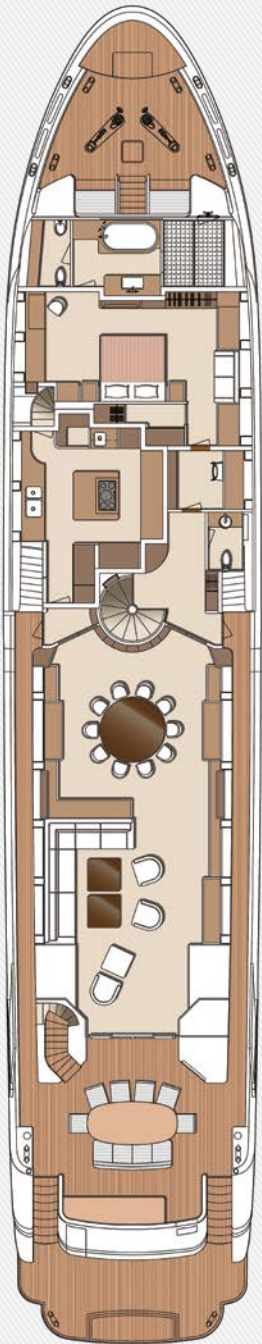

MAIN DECK

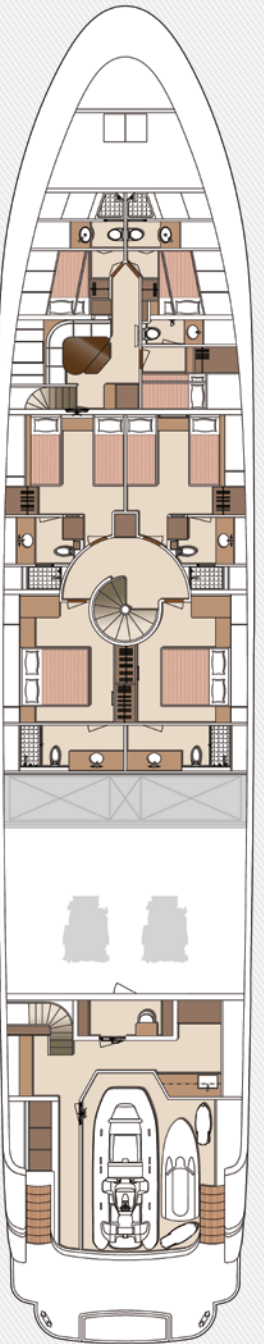

LOWER DECK



# P140

*A Collaboration in Innovation*

## **DARING TO DREAM BIGGER.**

Born from the success of Horizon's previous superyachts, the P140 model was designed for both superior performance and interior functionality. The P140 offers a six-stateroom layout within her 28ft (8.52m) beam as well as voluminous main-deck salon, formal dining for up to ten guests, a skylounge salon and numerous outdoor spaces. In 2019, the P140 assumed the record previously held by the P130 *Miss Rose* as the world's largest single-infused FRP hull. Featuring a bulbous bow for stability and performance, the P140 is built to RINA classification under EPA (Environmental Protection Agency) and IMO (International Maritime Organization) MARPOL regulations during construction.







**advanced technology +  
multifunctional design**





**superior design**  
**superior performance**



**THESE PAGES**

The P140 is designed with performance in mind, from her bulbous bow and streamlined hull to her advanced composites construction technologies.



# P140 Specifications and Layout

L.O.A.	136' (41.45m)
L.W.L.	122' 6" (37.24m)
Beam	28' (8.52m)
Draft (half load)	7' 4" (2.2m)
Displacement (half load)	588,600lbs (267 tons)
Fuel Capacity	12,700 US gals (48,100ltrs)
Fresh Water Capacity	1,770 US gals (6,700ltrs)
Engines	Twin MAN D2862LE438 1,200hp
Generators	Twin Onan 65kW (50Hz) or Twin Onan 65kW (60Hz)

## CUSTOMIZATION CAPABILITIES

Triple decks bring triple luxuries. With its extended length and volume, the P140 is truly a tailor-made megayacht that allows owners to define their dream exterior and interior layout.

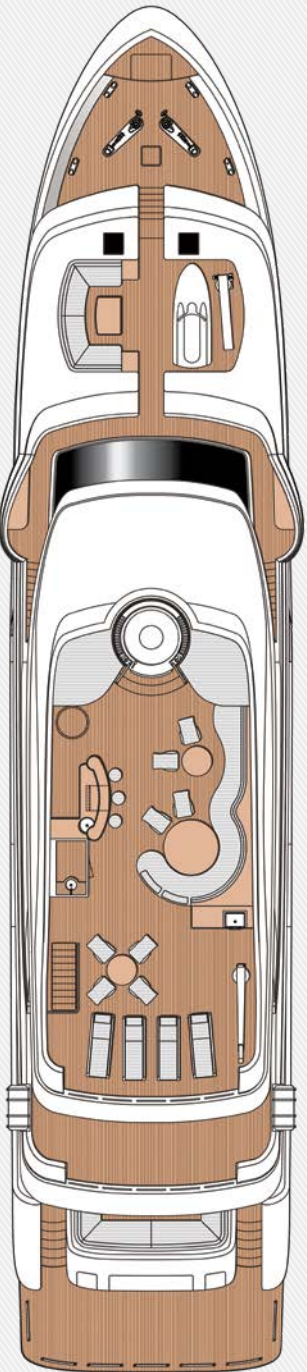
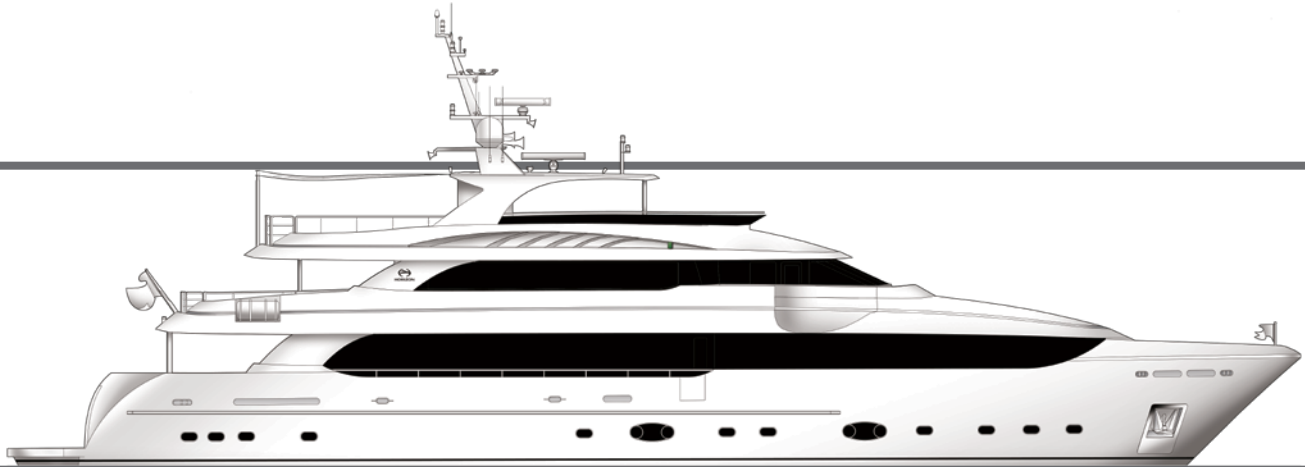

SUN DECK

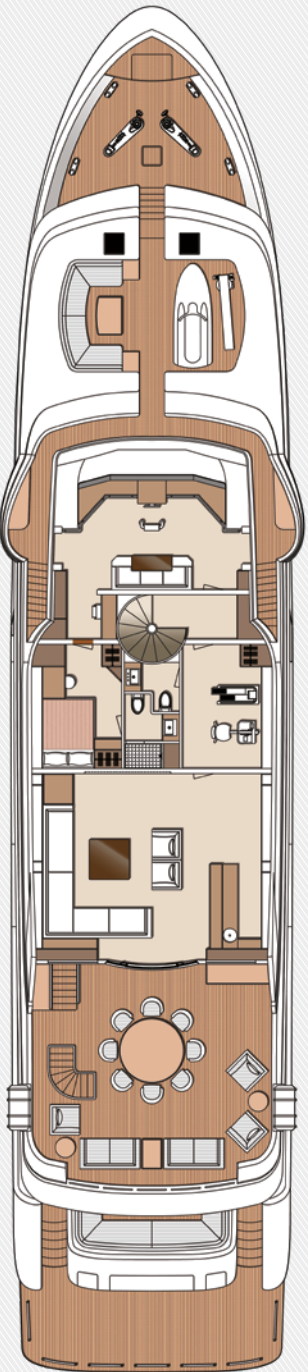

BRIDGE DECK

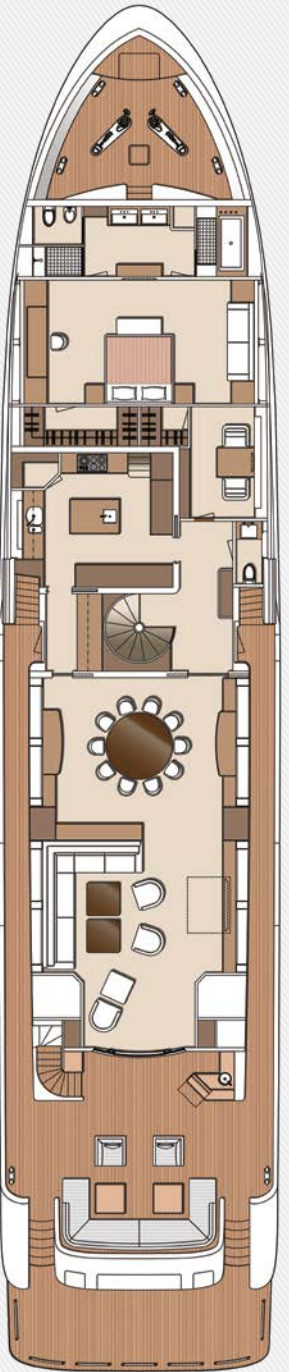

MAIN DECK

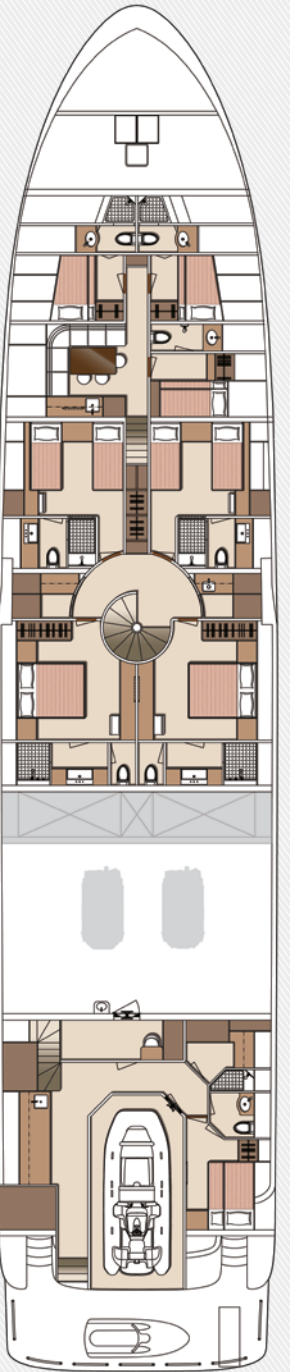

LOWER DECK



# Our Owners Don't Chase Dreams, They Define Them

## PUSHING THE ENVELOPE.

For more than 34 years, Horizon has been pioneering the design and build of exceptional motoryachts for discerning owners. Leaders in advanced composite technologies and naval architecture, Horizon sets the standards for innovation so our owners can confidently define their dreams.

### ASSOCIATIONS



### AWARDS



All GAs, layouts and specifications shown represent actual builds and designs at the time of publication but are subject to change without notice.





*DEFINE YOUR HORIZON*

