

E SERIES

  
**HORIZON**  
WORLD CLASS YACHTS



E75 // E81 // E90 // E100





## TIMELESS LUXURY

"The E Series is the first of Horizon's luxury yacht series to feature elegant European exterior styling, which has come to be recognized by clients around the globe. To date, Horizon has delivered over 100 E Series yachts, each of which seamlessly blends this signature styling with the yacht's overall hull shape and design, underscoring Horizon's capability as a semi-custom yacht builder." — CEO John Lu

# Defining the E Series

## ELEGANCE

Characterized by the signature sleek exterior profile, the E Series yacht blends European luxury and elegance with functional design.

## FLEXIBILITY

The E Series offers four models in a multitude of layout configurations with endless options for customization that satisfy any cruising lifestyle.

## PERFORMANCE

Designed with safety and comfortable cruising in mind, the E Series hull delivers the most reliable, stable and responsive boating experience on the water.



# Current Models

## E75

Elegant and Functional



OPEN BRIDGE



SKYLounge

## E81

Innovative Mid-Sized Luxury



OPEN BRIDGE



SKYLounge

## E90

Well-Planned Living and Entertaining Spaces



## E100

Superyacht Amenities in an Efficient Package



OPEN BRIDGE



SKYLounge

### THE EVOLUTION OF DESIGN

Each model in the E Series is the result of a design evolution accommodating an owner's vision and a shipyard's mission.

This impressive series of yachts suits endless cruising styles.



# Models & Configurations





# E75

*Elegant and Functional*

## AN EVOLUTION IN DESIGN.

The Horizon E75 motoryacht is an evolution in design of an earlier, extremely popular E73 model.

Boasting a stylish exterior with appealing lines, the E75's interior features increased volume and

numerous entertaining areas. Entertaining with family and friends becomes a true pleasure

aboard the E75, which offers a creative foredeck seating area, an exterior bar on the boat deck,

and an incredible aft deck for shaded relaxation. This is a yacht that defies size perception and

provides the amenities and space of a far larger yacht in an attractive profile.







Main Salon

**THESE PAGES**

The optional galley-aft configuration positions the large salon amidships while the galley can easily service the spacious aft deck.





**spread out and  
relax in your  
preferred layout**



Galley Forward



Main Salon





Bridge Deck Aft

**THESE PAGES**

The bridge deck aft features a bar with refrigerator and barbecue grill. The foredeck is fitted with sunpads and a dinette for eight guests.



Main Deck Aft



**enjoy the journey  
as well as the destination**



# E75 Specifications and Layout

L.O.A.	76' 3" (23.24m)
L.W.L.	64' 3" (19.59m)
Beam	18' 6" (5.64m)
Draft (half load)	5' 9" (1.76m)
Displacement (half load)	117,373lbs (53.24 tons)
Fuel Capacity	1,720 US gals (6,500ltrs)
Fresh Water Capacity	400 US gals (1,500ltrs)
Engines	Twin CAT C18A 1,136bhp
Generators	Twin Onan 22.5kW (50Hz) or Twin Onan 29kW (60Hz)

## SPECIAL FEATURES

Offered in an Open Bridge or Skylounge configuration, the Horizon E75 has been designed to suit a variety of cruising lifestyles. Horizon works with each owner to customize interior and exterior amenities, and to ensure that the yacht suits the client's tastes perfectly.

## PROFILE OPTIONS: OPEN BRIDGE & SKYLounge

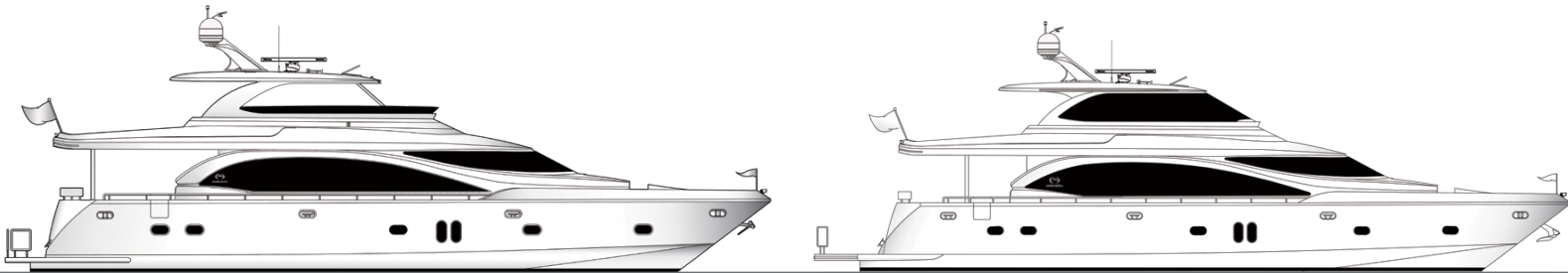

## Open Bridge Layout

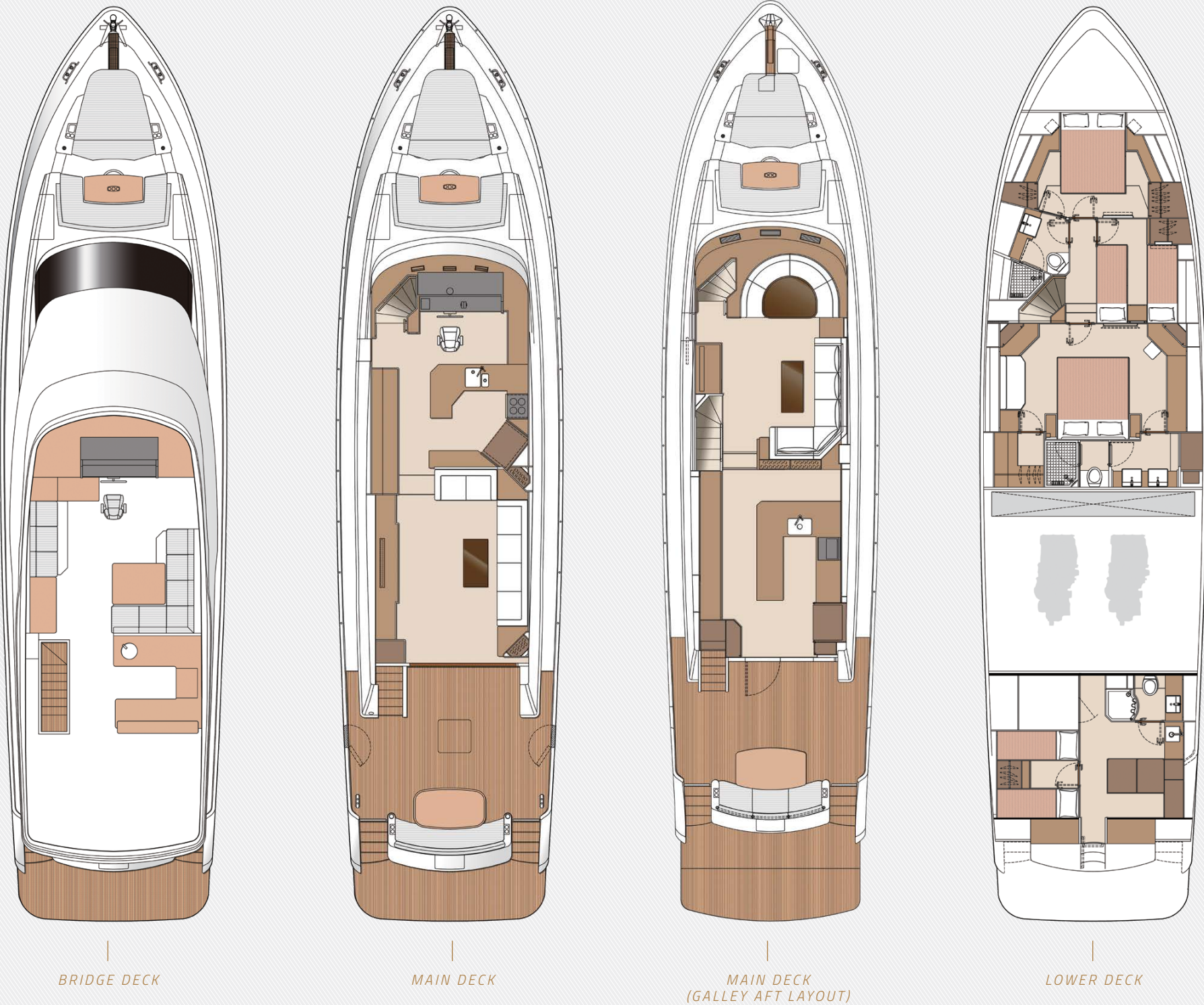



# E81

*Innovative Mid-Sized Luxury*

## **FLEXIBILITY AND FUNCTIONALITY.**

The newest model in the ever-popular E Series, the E81 marries the sleek E Series superstructure profile design with a beamy, high-performance hull. This high-volume model offers a 20' 6" beam, which allows for up to four roomy staterooms and accommodates a variety of engine options, without compromising performance or draft. With the E81, you can customize the interior layout to your liking and select the power and performance to get you to your destination as you wish. Offering the flexibility of being an owner-operated or crewed vessel, the E81 is available in enclosed bridge or open bridge configurations.







Main Deck Forward

**an interior  
customized to  
your style**



Main Salon





Master Stateroom



**THESE PAGES**

The full-beam master is situated amidships, with two convertible twin staterooms to port and starboard and a spacious VIP in the bow.



Forward VIP Stateroom







Main Deck Aft

**THESE PAGES**

Outdoor areas are maximized on the E81, with an expansive open flybridge protected by a hard top and a fixed glass windshied forward.

Flybridge



# E81 Specifications and Layout

L.O.A.	83' 1" (25.32m)
L.W.L.	72' 5" (22.08m)
Beam	20' 6" (6.25m)
Draft (half load)	5' 11" (1.82m)
Displacement (half load)	153,882lbs (69.8 tons)
Fuel Capacity	2,300 US gals (8,706ltrs)
Fresh Water Capacity	300 US gals (1,135ltrs)
Engines	Twin CAT C32A 1,600hp T3R
Generators	Twin Onan 22.5kW (50Hz) or Twin Onan 29kW (60Hz)

PROFILE OPTIONS:  
OPEN BRIDGE  
& SKYLounge

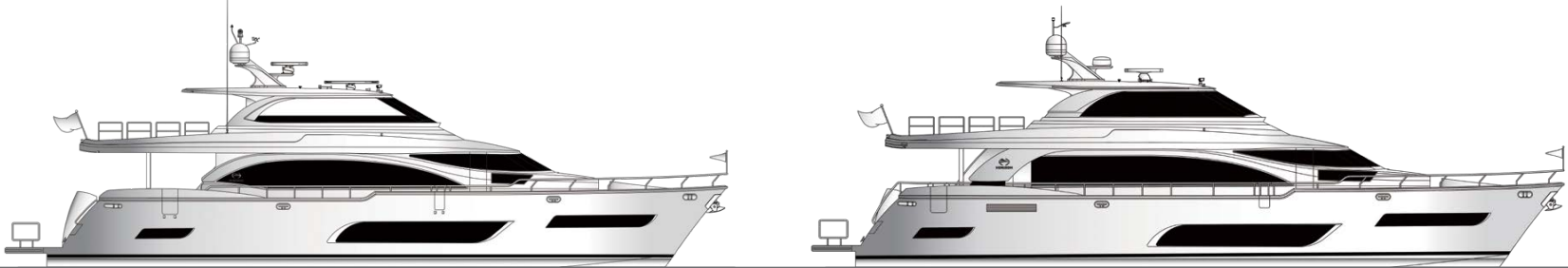

## SPECIAL FEATURES

The E81 is available in Open Bridge and Skylounge configurations. Owners have the option of fitting their yacht for crew service or owner operation with the four-stateroom layout and aft crew quarters.

Open Bridge Layout

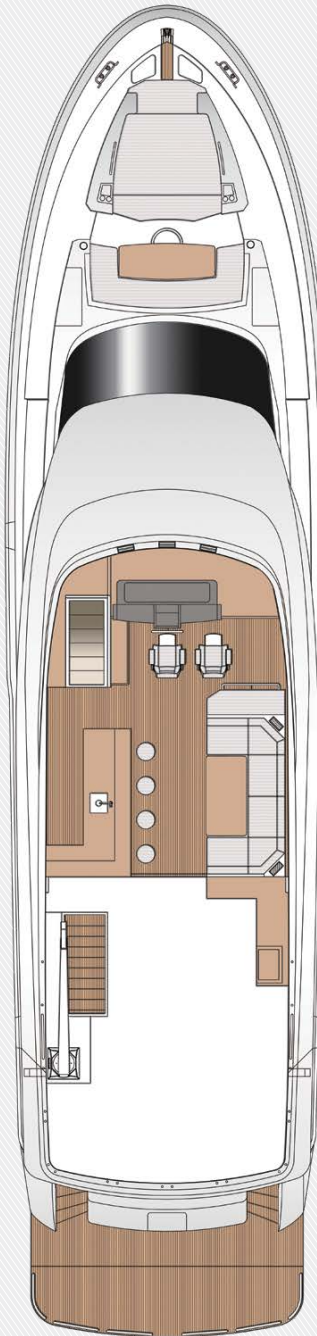

BRIDGE DECK



MAIN DECK

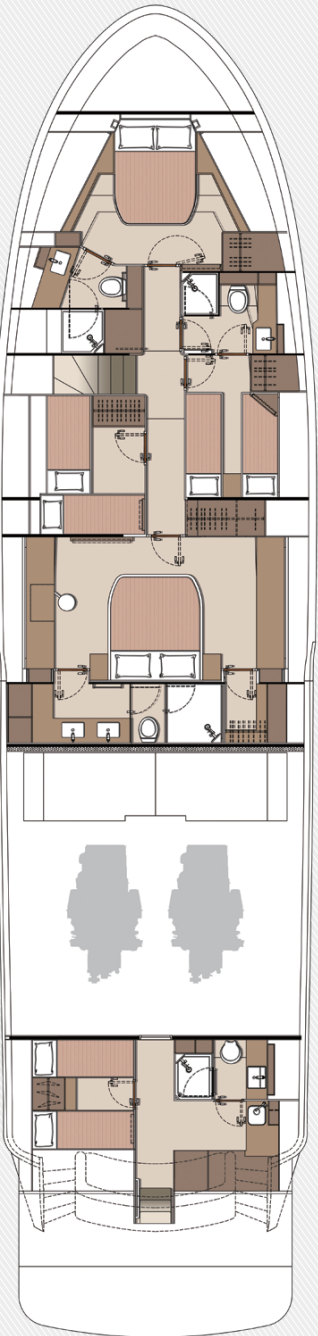

LOWER DECK



# E90

*Well-Planned Living and Entertaining Spaces*

## **MULTI-FUNCTIONAL EXTERIOR AREAS AND SUPERYACHT SPACE.**

The Horizon E90 is the next-generation model of the E Series – a stylish vessel that combines a performance-oriented hull with a sleek superstructure. Today's E90 features four ensuite staterooms and crew quarters for four within a flexible and multi-functional layout. The spacious main deck offers a large country kitchen forward, while the upper deck offers an enclosed wheelhouse with a dinette, wet bar, Jacuzzi and sunpads aft. Designed with island-living luxury in mind, the Horizon E90 offers the ultimate comfortable cruising experience.







Main Salon

THESE PAGES

Bright and spacious, with a modern lighting design, the salon incorporates a sizable L-shaped sofa and armchair that invites conversation and relaxation.







Master Suite

**THESE PAGES**  
From the bridge deck to the lower deck, each area is efficiently designed and well appointed.



Main Deck Forward





#### THESE PAGES

Designed for socializing and entertaining, the deck areas aboard the E90 are comfortable and spacious.

Bridge Deck Aft



# E90 Specifications and Layout

L.O.A.	89' 4" (27.24m)
L.W.L.	77' (23.48m)
Beam	21' (6.4m)
Draft (half load)	5' 4" (1.64m)
Displacement (half load)	182,300lbs (82.7 tons)
Fuel Capacity	2,700 US gals (10,220ltrs)
Fresh Water Capacity	500 US gals (1,890ltrs)
Engines	Twin CAT C32A 1,600hp
Generators	Twin Onan 27kW (50Hz) or Twin Onan 29kW (60Hz)

## SPECIAL FEATURES

The E90 has enjoyed immense success around the world for her sleek style lines, performance oriented hull, and spacious accommodations.

The Horizon E90 is designed with island-living luxury in mind, providing its owners the ultimate comfortable cruising experience.

PROFILE OPTION:  
SKYLounge

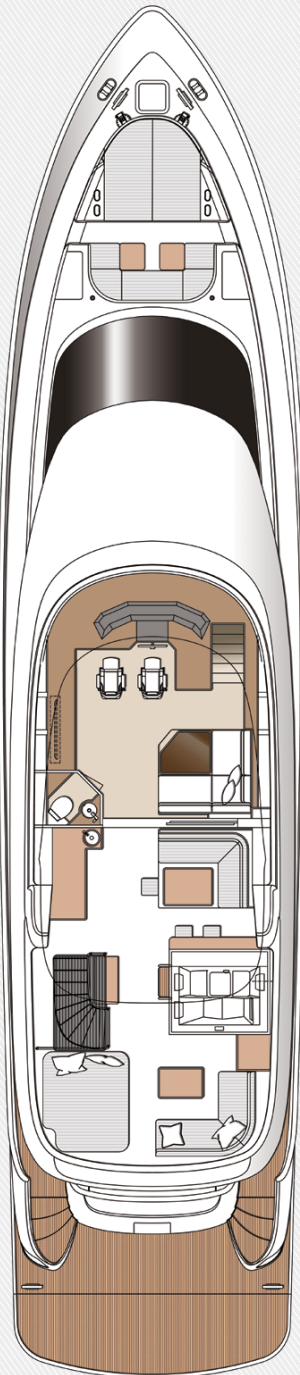

BRIDGE DECK

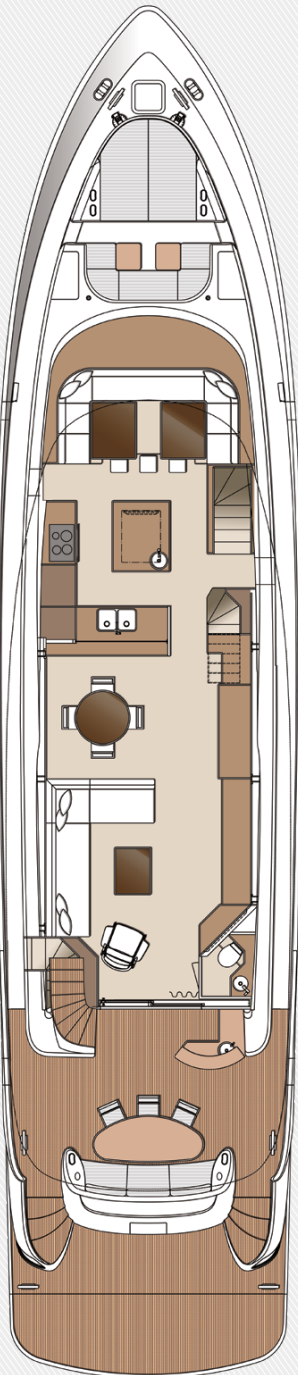

MAIN DECK

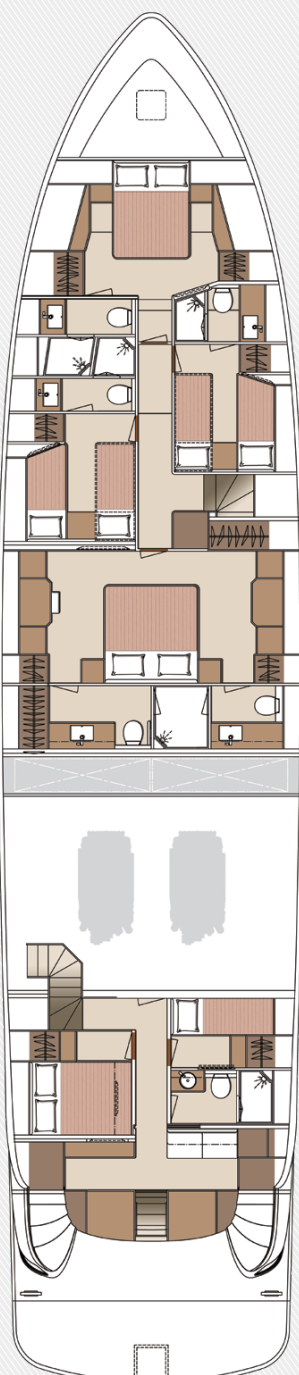

LOWER DECK



# E100

*Superyacht Amenities in an Efficient Package*

## DESIGNED TO APPEAL TO ALL YACHTING LIFESTYLES.

The Horizon E100 is currently the largest motoryacht in the E series, and was designed for clients who wish to enjoy the comforts of a superyacht in a sub-100ft (30m) motoryacht. Designed by Swedish designer John Lindblom, her sleek exterior lines exude a timeless style, while her high-performance hull ensures cruising efficiency, stability and seakeeping. The Horizon E100 is offered in Skylounge and Open Bridge versions and features an expansive aft deck as well as a foredeck seating area to suit a variety of cruising lifestyles.





**THESE PAGES**  
The standard layout includes a main salon, formal dining, galley and country kitchen forward on the main deck. As shown, this layout has no formal dining and instead offers an enlarged salon and breakfast bar.







Main Deck Forward

**your  
waterfront  
oasis**





Master Suite

**THESE PAGES**

The E100 offers a functional four-ensuite-stateroom layout, with crew quarters for four aft of the engine room.







**yacht ownership  
without compromise**





# E100 Specifications and Layout

L.O.A.	99' 6" (30.33m)
L.W.L.	86' 3" (26.3m)
Beam	23' 2" (7.07m)
Draft (half load)	6' (1.83m)
Displacement (half load)	235,890lbs (107 tons)
Fuel Capacity	4,500 US gals (17,000ltrs)
Fresh Water Capacity	600 US gals (2,270ltrs)
Engines	Twin CAT C32A 1,600hp
Generators	Twin Onan 40kW (50Hz) or Twin Onan 40kW (60Hz)

## SPECIAL FEATURES

The E100 boasts an impressive 6' (1.83m) draft, which allows the flexibility to cruise in the shallow waters of desirable locations such as The Bahamas. Within its 23' 2" (7.07m) beam, the E100 provides plenty of space to comfortably accommodate family and friends on every deck.

## PROFILE OPTIONS: OPEN BRIDGE & SKYLounge

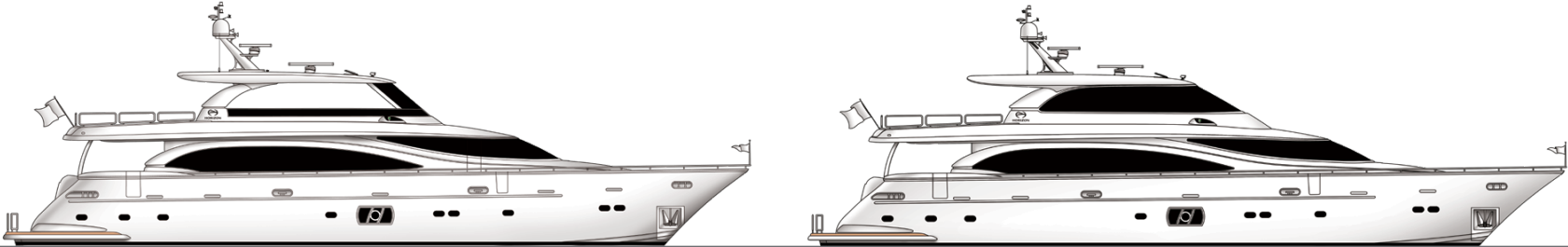

## Open Bridge Layout

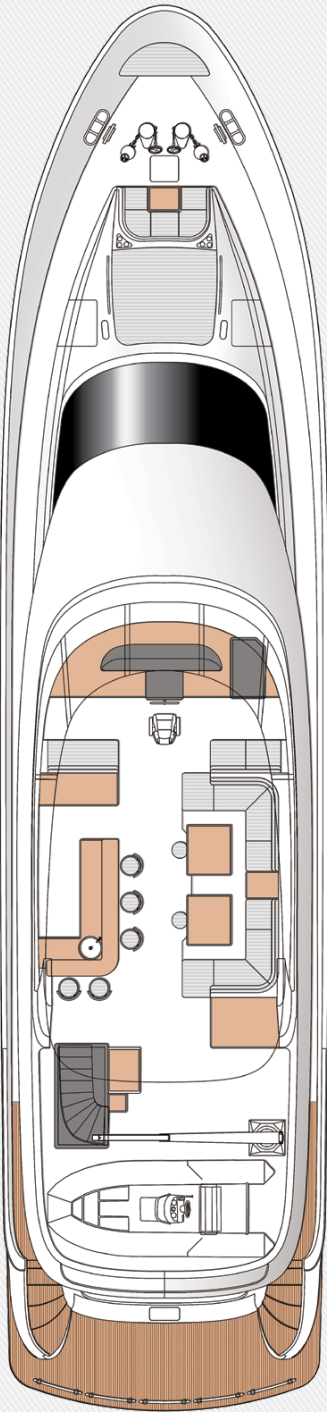

BRIDGE DECK



MAIN DECK

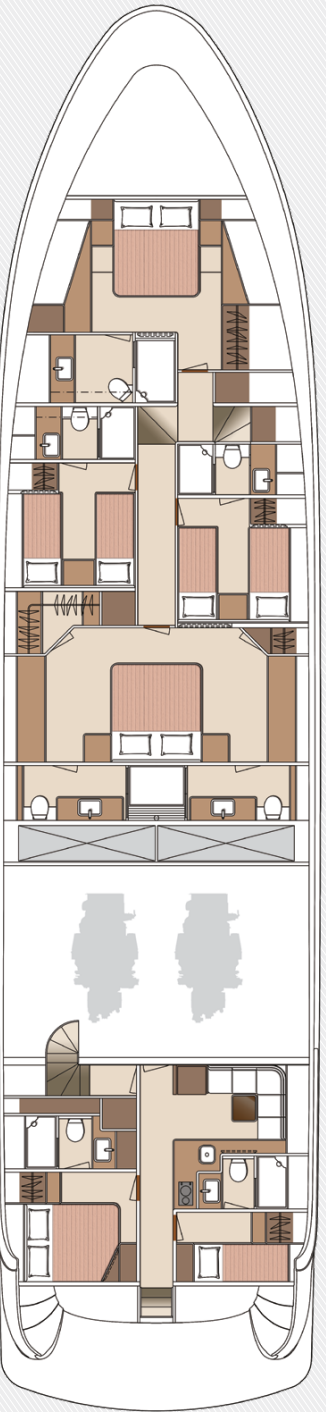

LOWER DECK



# Our Owners Don't Chase Dreams, They Define Them

**PUSHING THE ENVELOPE.**

For more than 35 years, Horizon has been pioneering the design and build of exceptional motoryachts for discerning owners. Leaders in advanced composite technologies and naval architecture, Horizon sets the standards for innovation so our owners can confidently define their dreams.

ASSOCIATIONS



AWARDS



All GAs, layouts and specifications shown represent actual builds and designs at the time of publication but are subject to change without notice.





*DEFINE YOUR HORIZON*

